

AFFIDAVIT OF SERVICE OF MAILING

State of Washington)
County of King)
City of Issaquah)

CARLA ZABRISKIE, being first duly sworn, upon oath, deposes and states:

That on the 12th day of SEPTEMBER, 2018, I deposited in the mail of the United States a sealed envelope containing a public hearing notice, decision or recommendation with postage prepaid addressed to the adjacent property and/or parties of record in the below entitled application or petition.

NOTICE OF APPLICATIONS: SDPI8-00001, ASDPI8-00006, ASDPI8-00007
AND PUBLIC HEARING HIGH STREET COLLECTION @ IH, ISSAQUAH HIGHLANDS
SELF STORAGE, MEDICAL OFFICE BUILDING.

Carla Zabriske

Signed by

SUBSCRIBED AND SWORN to before me this 12th day of September, 2018



Jennifer A. Woods
Notary Public in and for the State of Washington
residing at Bothell, WA, therein.

Notice of Application and Public Hearing



CITY OF
ISSAQUAH
WASHINGTON

Development Services Department
1775 12th Ave. NW, P.O. Box 1307
Issaquah, WA 98027
425-837-3100 DSD@issaquahwa.gov

<p>Project Name: High Street Collection at Issaquah Highlands</p>	<p>Time: Wednesday Sept. 26, 2018, 7:00 pm</p> <p>Place: Pickering Room, City Hall Northwest, 1775 12th Ave NW</p> <p>By: Development Commission (DC)</p>
---	--

<p>PROJECT INFORMATION</p> <p>File Number(s): SDP18-00001</p> <p>Project Description: Development of a one-story retail development in 11 buildings containing entertainment, retail, daily goods and services, and restaurants. The buildings total 111,000 sf on 10.3 acres with 485 surface parking stalls. An additional 7,900 sq.ft. of second story retail, restaurant, or deck space is possible. (See attached site plan)</p> <p>Project Location: Block A, Block B, northern portion of Block C Issaquah Highlands; 9th Ave NE between High St and Discovery Dr. (See attached Vicinity Map)</p> <p>Size of Subject Area in Acres: 10.3 Sq. Ft.: 448,267</p> <p>Applicant: Scott Hougham/MG2, 1102 2nd Ave, Ste 100, Seattle WA 98101, 206-962-6502, scott.hougham@MG2.com</p> <p>Decision Maker: DC - Level 3 process</p> <p>Required City Permits: SDP, SEPA</p> <p>Required City Permits, Not Part of this Application: such as: Building Permit, Site Work Permit</p> <p>Required Studies: such as: to be determined</p> <p>Existing Environmental Documents Relevant to this Application: such as: Traffic Study</p>
--

<p>PUBLIC HEARING INFORMATION</p> <p>Key application documents are available at the City’s website: issaquahwa.gov/development. Click on the parcel, then select “View Related Documents and Permits” to see the available submittals. The application, with full size plans, is available for review at the Permit Center, City Hall Northwest, 1775 12th Avenue NW (next to Holiday Inn and behind Lowe’s), 9 am – 5 pm. Please make an appointment with the Project Planner.</p> <p>Comments will be accepted up to and during the Public Hearing. Written comments should be directed to:</p> <p style="padding-left: 40px;">Development Services Department P.O. Box 1307, Issaquah, WA 98027</p> <p>Or by e-mail to the Project Planner noted below.</p> <p>To receive further public notices on this project please provide your name, address, and e-mail to the Project Planner and request to become a Party of Record.</p> <p><i>Notice is required to be provided to property owners within 300 feet of the site and to Parties of Record. Please share this notice with others in your neighborhood who may be interested in this project. Property owner, Mortgagee, Lien Holder, Vendor, Seller, etc., please share this notice with tenants and others who may be interested in this project.</i></p>

<p>REGULATORY INFORMATION</p> <p>Zoning: UV-COM/RET – Urban Village Commercial/Retail</p> <p>Comprehensive Plan Designation: Urban Village</p> <p>Consistent With Comprehensive Plan: Yes</p> <p>Preliminary Determination of the Development Regulations that will be used for Project Mitigation and Consistency: such as: Issaquah Highlands Replacement Regulations, Central Issaquah Development and Design Standards (Online at: issaquahwa.gov/codes_and_plans)</p>
--

<p>PUBLIC HEARING NOTES:</p> <ul style="list-style-type: none"> ▪ The proposal may change as a result of the public review process. ▪ Input from the public will be documented in the permit file and forwarded to the Development Commission for their consideration. ▪ The decision, once rendered, is appealable.
--

<p>CITY CONTACT INFORMATION</p>			
<p>Project Planner: Lucy Sloman, Land Development Mgr</p> <p>Phone Number: 425-837-3433</p> <p>E-Mail: lucys@issaquahwa.gov</p>	<p>Development Services Department:</p> <p>Phone Number: 425-837-3100</p> <p>E-Mail: DSD@issaquahwa.gov</p>		

HIGH STREET COLLECTION AT ISSAQUAH HIGHLANDS

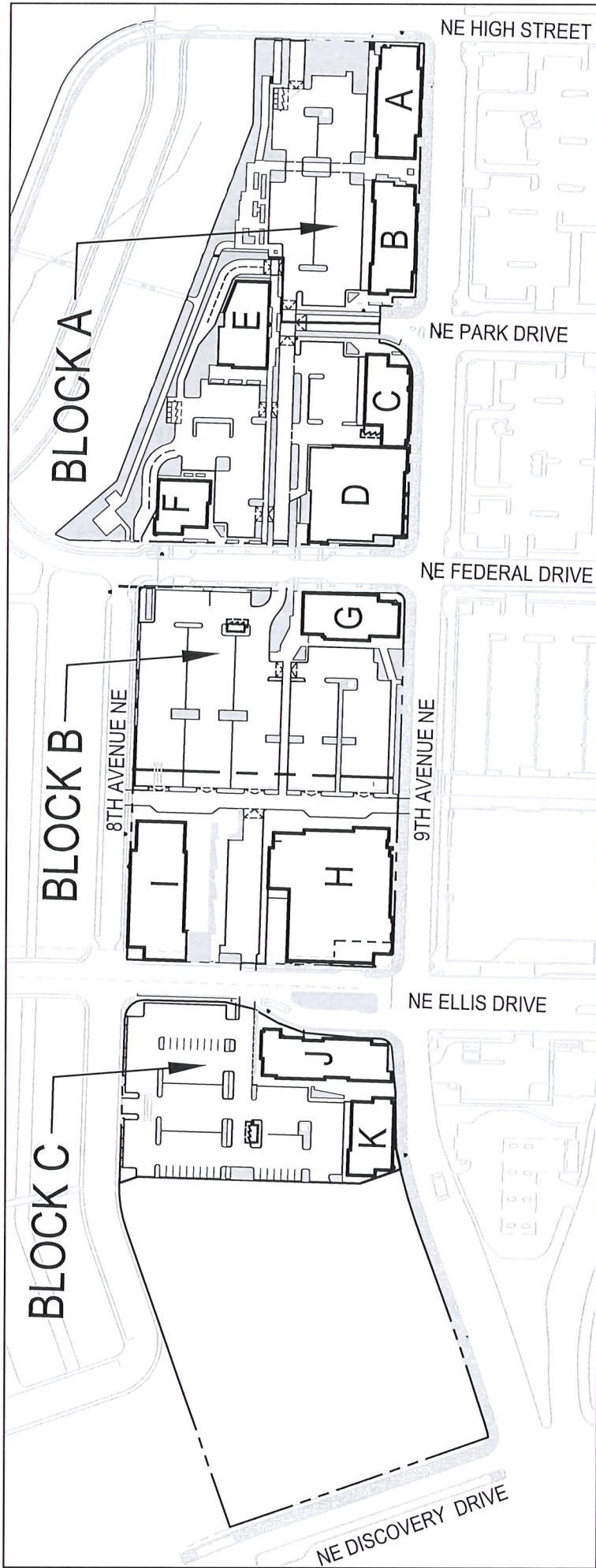

Site Plan

SCALE: 1" = 200'-0"

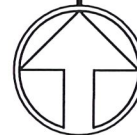

The IHIF Commercial LLC High Street Collection is a proposal to build 111,100 - 119,000 SF of entertainment, retail, daily goods and services and restaurants. The proposal consists of 11 buildings, on 5 lots, with off-street surface parking for 485 stalls. The buildings will primarily be single-story retail with opportunities for an additional 7,900 SF of second story retail, restaurants or deck space to take advantage of views from the site. This second story option would increase the total building area to 119,000 SF.

Notice of Application and Public Hearing

**CITY OF
ISSAQUAH
WASHINGTON**
Development Services Department
1775 12th Ave. NW, P.O. Box 1307
Issaquah, WA 98027
425-837-3100 DSD@issaquahwa.gov

Project Name:
Issaquah Highlands Self Storage

Time: Wednesday Sept. 26, 2018, 7:00 pm
**Place: Pickering Room, City Hall Northwest,
1775 12th Ave NW**

By: Development Commission (DC)

PROJECT INFORMATION

File Number(s): ASDP18-00006

Project Description: Build a self-storage building containing 3-stories and a basement. The building has approximately 105,000 sf and 34 surface parking stalls. (See attached site plan)

Project Location: Northwest corner of NE Discovery Dr. and 6th Avenue NE (See attached Vicinity Map)

Size of Subject Area in Acres: 0.8 Sq. Ft.: 35,805

Applicant: William Bilyeu/Jackson Main Architects, 311 1st Ave South, Seattle WA 98104, 206-324-4800, William.bilyeu@jacksonmain.com

Decision Maker: DC - Level 3 process

Required City Permits: ASDP, SEPA

Required City Permits, Not Part of this Application: such as: Building Permit, Site Work Permit

Required Studies: such as: to be determined

Existing Environmental Documents Relevant to this Application: such as: Traffic Study

PUBLIC HEARING INFORMATION

Key application documents are available at the City's website: issaquahwa.gov/development. Click on the parcel, then select "View Related Documents and Permits" to see the available submittals. The application, with full size plans, is available for review at the Permit Center, City Hall Northwest, 1775 12th Avenue NW (next to Holiday Inn and behind Lowe's), 9 am – 5 pm. Please make an appointment with the Project Planner.

Comments will be accepted up to and during the Public Hearing. Written comments should be directed to:

Development Services Department
P.O. Box 1307, Issaquah, WA 98027

Or by e-mail to the Project Planner noted below.

To receive further public notices on this project please provide your name, address, and e-mail to the Project Planner and request to become a Party of Record.

Notice is required to be provided to property owners within 300 feet of the site and to Parties of Record. Please share this notice with others in your neighborhood who may be interested in this project. Property owner, Mortgagee, Lien Holder, Vendor, Seller, etc., please share this notice with tenants and others who may be interested in this project.

REGULATORY INFORMATION

Zoning: UV-COM/RET – Urban Village Commercial/Retail

Comprehensive Plan Designation: Urban Village

Consistent With Comprehensive Plan: Yes

Preliminary Determination of the Development Regulations that will be used for Project Mitigation and Consistency: such as: Issaquah Highlands Replacement Regulations, **Central Issaquah Development and Design Standards** (Online at: [issaquahwa.gov/codes and plans](http://issaquahwa.gov/codes_and_plans))

PUBLIC HEARING NOTES:

- The proposal may change as a result of the public review process.
- Input from the public will be documented in the permit file and forwarded to the Development Commission for their consideration.
- The decision, once rendered, is appealable.

CITY CONTACT INFORMATION

Project Planner: Lucy Sloman, Land Development Mgr.
Phone Number: 425-837-3433
E-Mail: lucys@issaquahwa.gov

Development Services Department:
Phone Number: 425-837-3100
E-Mail: DSD@issaquahwa.gov

Notice of Application and Public Hearing



Project Name:
Medical Office Building

Time: **Wednesday Sept. 26, 2018, 7:00 pm**

Place: **Pickering Room, City Hall Northwest,
1775 12th Ave NW**

By: **Development Commission (DC)**

PROJECT INFORMATION

File Number(s): ASDP18-00007

Project Description: Build a 4-story medical office building containing about 92,400 sf. 394 parking stalls will be provided primarily in a parking deck. (See attached site plan)

Project Location: NE Discovery Dr. between 6th and 8th Avenues NE (See attached Vicinity Map)

Size of Subject Area in Acres: 2.82 Sq. Ft.: 123,102

Applicant: David Holmes/CollinsWoerman, 710 2nd Ave, Ste 1400, Seattle WA 98104, 206-245-2018, dholmes@collinswoerman.com

Decision Maker: DC - Level 3 process

Required City Permits: ASDP, SEPA

Required City Permits, Not Part of this Application: such as: Building Permit, Site Work Permit

Required Studies: such as: to be determined

Existing Environmental Documents Relevant to this Application: such as: Traffic Study

PUBLIC HEARING INFORMATION

Key application documents are available at the City's website: issaquahwa.gov/development. Click on the parcel, then select "View Related Documents and Permits" to see the available submittals. The application, with full size plans, is available for review at the Permit Center, City Hall Northwest, 1775 12th Avenue NW (next to Holiday Inn and behind Lowe's), 9 am – 5 pm. Please make an appointment with the Project Planner.

Comments will be accepted up to and during the Public Hearing. Written comments should be directed to:

Development Services Department
P.O. Box 1307, Issaquah, WA 98027

Or by e-mail to the Project Planner noted below.

To receive further public notices on this project please provide your name, address, and e-mail to the Project Planner and request to become a Party of Record.

Notice is required to be provided to property owners within 300 feet of the site and to Parties of Record. Please share this notice with others in your neighborhood who may be interested in this project. Property owner, Mortgagee, Lien Holder, Vendor, Seller, etc., please share this notice with tenants and others who may be interested in this project.

REGULATORY INFORMATION

Zoning: UV-COM/RET – Urban Village Commercial/Retail

Comprehensive Plan Designation: Urban Village

Consistent With Comprehensive Plan: Yes

Preliminary Determination of the Development Regulations that will be used for Project Mitigation and Consistency: such as: Issaquah Highlands Replacement Regulations, **Central Issaquah Development and Design Standards** (Online at: issaquahwa.gov/codes_and_plans)

PUBLIC HEARING NOTES:

- The proposal may change as a result of the public review process.
- Input from the public will be documented in the permit file and forwarded to the Development Commission for their consideration.
- The decision, once rendered, is appealable.

CITY CONTACT INFORMATION

Project Planner: Lucy Sloman, Land Development Mgr.
Phone Number: 425-837-3433
E-Mail: lucys@issaquahwa.gov

Development Services Department:
Phone Number: 425-837-3100
E-Mail: DSD@issaquahwa.gov

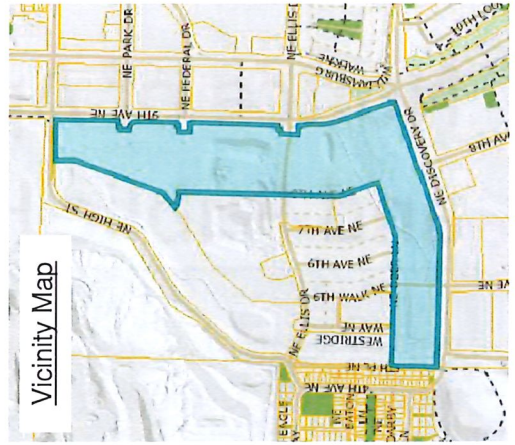

NEW MEDICAL OFFICE BUILDING - Site Plan



KEANE BRIAN+NOKNOI
1005 10TH AVE NE #4.6
ISSAQUAH, WA 98029

SIMMONS EDWARD C+KIMBERLY S
1045 10TH AVE NE
ISSAQUAH, WA 98029

TORRES TYLER+MICHELE
1093 10TH AVE NE #1.1
ISSAQUAH, WA 98029

PATEL JATINKUMAR K+PRIYANKA
1009 10TH AVE NE
ISSAQUAH, WA 98029

YANG LAUREN
1053 10TH AVE NE
ISSAQUAH, WA 98029

BLOCK 24 LLC
11100 MAIN ST #301
BELLEVUE, WA 98004

SHEN QIFEI+YUAN LYU
1011 10TH AVE NE
ISSAQUAH, WA 98029

SHEN HUIYING+QINGQING WEI
1057 10TH AVE NE #2.5
ISSAQUAH, WA 98029

BROWNSTONE AT ISSAQUAH HLND
11624 SE 5TH ST #200
BELLEVUE, WA 98005

ISSAQUAH HIGHLAND COMM
1011 NE HIGH ST #210
ISSAQUAH, WA 98029

SMART JUANITA M
1063 10TH AVE NE
ISSAQUAH, WA 98029

ISSAQUAH HIGHLANDS
11624 SE 5TH ST #200
BELLEVUE, WA 98005

KNOLL JON MICHAEL
1015 10TH AVE NE UNIT 4.3
ISSAQUAH, WA 98029

LIU TZU-HUA+YI-TING CHEN
1067 10TH AVE NE #2.2
ISSAQUAH, WA 98029

IHIF COMMERCIAL L L C
11624 SE 5TH ST STE #210
BELLEVUE, WA 98005

MATRINEZ CHRIS+DONNA
1021 10TH AVE NE
ISSAQUAH, WA 98029

LI TAI-CHING
1071 10TH AVE NE UNIT 2.1
ISSAQUAH, WA 98029

THE BROWNSTONE AT ISSAQUAH
11624 SE 5TH ST STE 200
ISSAQUAH, WA 98005

SUNG ABRAHAM L+APRIL S MOH
1029 10TH AVE NE
ISSAQUAH, WA 98029

SANTHANAKRISHNAN PRABAGARAN
1077 10TH AVE NE
ISSAQUAH, WA 98029

ZHONG SULING+NGUYEN DUY MIN
1215 N 45TH ST #425
SEATTLE, WA 98103

RAVEENDRANATHAN PRATHEEPAN+
1031 10TH AVE NE
ISSAQUAH, WA 98029

LIANG HONGFEI+HONGHUI LI
1083 10TH AVE NE
ISSAQUAH, WA 98029

GUO YANCHENG+KANG XUEYING
1302 WILLIAMSBURG WALK NE
ISSAQUAH, WA 98029

WANG YI+HU WENHUI
1035 10TH AVE NE
ISSAQUAH, WA 98029

DISCOVERY HEIGHTS III LLC
10900 NE 8TH ST #1200
BELLEVUE, WA 98004

KIM HWAKYUNG
1304 WILLIAMSBURG WALK NE
ISSAQUAH, WA 98029

KUMAR PAWAN+CHIKKANNA SHRUT
1043 10TH AVE NE
ISSAQUAH, WA 98029

BENNETT MARK J
1091 10TH AVE NE #1.2
ISSAQUAH, WA 98029

YAM WINNIE YU HAR
1305 BROOKLYN WALK NE
ISSAQUAH, WA 98029

SONG DAWEI+FEI TANG
1306 BROOKLYN WALK NE
ISSAQUAH, WA 98029

VANZANDWIJK PATRICK+LILY WE
1312 WILLIAMSBURG WALK NE
ISSAQUAH, WA 98029

VIJAYABASKER VIGNESH+RAJEEV
1318 WILLIAMSBURG WALK NE #25.
2
ISSAQUAH, WA 98029

WONG QUINCY KWAN-SUT+SIK YU
1306 WILLIAMSBURG WALK NE
ISSAQUAH, WA 98029

ADNAN MUHAIMENUL
1313 BROOKLYN WALK NE
ISSAQUAH, WA 98029

COSTON CRAIG A+LISA A
1319 GREENWICH WALK NE
ISSAQUAH, WA 98029

RINN DAVID +FANG YU
1307 BROOKLYN WALK NE
ISSAQUAH, WA 98029

CAROLYN KESSLER
1313 GREENWICH WALK NE
ISSAQUAH, WA 98029

QADRI ADNAN MOHAMMADQADRI A
1320 CHELSEA WALK NE
ISSAQUAH, WA 98029

JING WEN YUN+HONG GUO
1308 BROOKLYN WALK NE
ISSAQUAH, WA 98029

LOMAX KRISTEN A
1314 BROOKLYN WALK NE
ISSAQUAH, WA 98029

LIU DAVID+JENNIFER KYONG YI
1320 GREENWICH WALK NE
ISSAQUAH, WA 98029

MATHEW BOBBY T+CHANICAL
1308 WILLIAMSBURG WALK NE
ISSAQUAH, WA 98029

COADY COLLEEN ANNE
1314 GREENWICH WK NE
ISSAQUAH, WA 98029

GUZMAN PEDRO E+VERONICA GAU
1320 WILLIAMSBURG WALK NE
ISSAQUAH, WA 98029

REYNOLDS KRISTI L
1309 BROOKLYN WALK NE
ISSAQUAH, WA 98029

BRIODY JENNIFER
1316 GREENWICH WALK NE
ISSAQUAH, WA 98029

OBERG RUSSELL C+LOUGHMAN PA
1321 CHELSEA WK NE #8.5
ISSAQUAH, WA 98029

LEIGH KARL D+LACEY T
1310 BROOKLYN WALK NE
ISSAQUAH, WA 98029

KOLAC KARLO+XIUMIN XU
1316 WILLIAMSBURG WK NE
ISSAQUAH, WA 98029

CAVIT DAVID+KA YUET CHAU+CH
1322 GREENWICH WALK NE
ISSAQUAH, WA 98029

THORNTON KIRBY A+HAUFF ADAM
1310 WILLIAMSBURG WALK NE #26.
5
ISSAQUAH, WA 98029

KIM DOHOON+SARA S
1317 BROOKLYN WALK NE
ISSAQUAH, WA 98029

TUAN YEN+SOPHIA+MICHAEL
1324 BROOKLYN WALK NE
ISSAQUAH, WA 98029

TODD RALPH G
1311 GREENWICH WK NE
ISSAQUAH, WA 98029

GALLUCCI ANNE
1317 GREENWICH WALK NE
ISSAQUAH, WA 98029

NANCY COOK-WICKHAM
1324 CHELSEA WALK NE
ISSAQUAH, WA 98029

WALLACE LEWIS AVERY+PONSRI
1312 GREENWICH WALK NE
ISSAQUAH, WA 98029

RODRIGUEZ JOSE PEREZ
1318 GREENWICH WALK NE
ISSAQUAH, WA 98029

SALLES JULIANA
1325 BROOKLYN WALK NE
ISSAQUAH, WA 98029

FANG FANG+JAMES J SONG
1326 GREENWICH WALK NE
ISSAQUAH, WA 98029

LIDDLE PATRICIA N+GREGORY D
1332 BROOKLYN WALK NE
ISSAQUAH, WA 98029

HUANG PEI-YANG+HSIN-JU WONG
1344 BROOKLYN WALK NE
ISSAQUAH, WA 98029

TODD RALPH G+MARILYN L
1326 WILLIAMSBURG WALK NE #24,
1
ISSAQUAH, WA 98029

WANG YANG
1333 WILLIAMSBURG WALK NE
ISSAQUAH, WA 98029

COLLINS ADAM C+SHERI M
1345 BROOKLYN WALK NE
ISSAQUAH, WA 98029

YOO DONG HWI
1327 GREENWICH WALK NE
ISSAQUAH, WA 98029

ZHAO MAO+XU XIN
1333 BROOKLYN WALK NE
ISSAQUAH, WA 98029

NEVILLE BRIAN
1348 WILLIAMSBURG WALK NE
ISSAQUAH, WA 98029

PAIGE DAVID U
1328 BROOKLYN WALK NE
ISSAQUAH, WA 98029

LAI HUIWU
1333 CHELSEA WALK NE
ISSAQUAH, WA 98029

WAGNER RYAN WILLIAM+NANCY M
1350 WILLIAMSBURG WALK NE
ISSAQUAH, WA 98029

TAYLOR-BOYD SHANDA
1328 GREENWICH WALK NE
ISSAQUAH, WA 98029

TURBEVILLE GREGORY JOHN
1333 GREENWICH WALK NE
ISSAQUAH, WA 98029

REISS JEFFREY W+SUZANNE K B
1352 WILLIAMSBURG WALK NE
ISSAQUAH, WA 98029

BHEEMARAJAIAH ANAND+MEGHANA
1328 WILLIAMSBURG WALK NE
ISSAQUAH, WA 98029

TONG XUENA
1336 BROOKLYN WALK NE
ISSAQUAH, WA 98029

RIMOLI SILVANA Y+ASSUMPCAO
1353 GREENWICH WALK NE
ISSAQUAH, WA 98029

LIU XINYI
1329 BROOKLYN WALK NE
ISSAQUAH, WA 98029

SICH RAYMOND
1340 BROOKLYN WALK NE 13.5
ISSAQUAH, WA 98029

SIEM MICHAEL S+STEPHANIE YA
1354 BROOKLYN WALK NE
ISSAQUAH, WA 98029

MARTINEZ MARIO R
1329 GREENWICH WALK NE
ISSAQUAH, WA 98029

WILLOUGHBY CHRISTOPHER+DACE
1341 BROOKLYN WALK NE
ISSAQUAH, WA 98029

HOU DAOQI+HUI ZHOU
1355 BROOKLYN WALK NE
ISSAQUAH, WA 98029

BAO JIANQI
1330 GREENWICH WALK NE
ISSAQUAH, WA 98029

ARMA SIDDHARTH AND BAMBA AA
1341 CHELSEA WALK NE UNIT 8.2
ISSAQUAH, WA 98029

CHIN GORDON S+FENNY C LU
1355 CHELSEA WALK NE #7.5
ISSAQUAH, WA 98029

BAROT JAIMIN+NUTAN CHANDRAK
1330 WILLIAMSBURG WALK NE
ISSAQUAH, WA 98029

CHOW CHRISTINE OI WAN
1341 GREENWICH WALK NE
ISSAQUAH, WA 98029

TONG YANG+DONG LI
1356 GREENWICH WALK NE
ISSAQUAH, WA 98029

ALATALO JANNE MIKAEL+SUSA H
1356 WILLIAMSBURG WALK NE
ISSAQUAH, WA 98029

GCJ INVESTMENT I LLC
1366 BROOKLYN WALK NE #12.4
ISSAQUAH, WA 98029

GRAND RIDGE PLAZA II LLC
1371 OAKLAND BLVD STE 200
WALNUT CREEK, CA 94596

LIN YUE
1358 BROOKLYN WALK NE #12.2
ISSAQUAH, WA 98029

SHEN DAN
1366 GREENWICH WALK NE
ISSAQUAH, WA 98029

WU JUN+RUI ZHANG
1372 GREENWICH WALK NE
ISSAQUAH, WA 98029

ALVAREZ THOMAS F+JUDY LI
1359 BROOKLYN WALK NE
ISSAQUAH, WA 98029

KALRA ASHISH+SHWETA JHA
1366 WILLIAMSBURG WALK NE
ISSAQUAH, WA 98029

YAN HONGMEI
1372 WILLIAMSBURG WALK NE
ISSAQUAH, WA 98029

PRIEUR AYMERIC R+DAKOTA G
1359 CHELSEA WALK NE
ISSAQUAH, WA 98029

TEMPEL MARK A+ KIMBERLEE S
1367 BROOKLYN WALK NE
ISSAQUAH, WA 98029

ADAMA PRAVEEN KUMAR REDDY
1374 BROOKLYN WALK NE #12.6
ISSAQUAH, WA 98029

DONG YUN
1359 GREENWICH WALK NE
ISSAQUAH, WA 98029

SUN WEI
1367 CHELSEA WALK NE #7.2
ISSAQUAH, WA 98029

YOSHINARI KENJI+ZOE B
1374 CHELSEA WALK NE #6.1
ISSAQUAH, WA 98029

GCJ INVESTMENT II LLC
1362 BROOKLYN WALK NE #12.3
ISSAQUAH, WA 98029

NARISSAWA MASUKO TAKHASHI
1368 WILLIAMSBURG WALK NE
ISSAQUAH, WA 98029

MIAO WANG
1375 BROOKLYN WALK NE UNIT 16.
1
ISSAQUAH, WA 98029

TUJPO JAMES+LEANN
1362 WILLIAMSBURG WALK NE
ISSAQUAH, WA 98029

WEI ZHENG
1369 GREENWICH WALK NE
ISSAQUAH, WA 98029

SOLOWAY BRENT H
1375 GREENWICH WK NE
ISSAQUAH, WA 98029

KILZI MARNI L+NADIM G
1363 BROOKLYN WALK NE
ISSAQUAH, WA 98029

REN BAOQIN+JIANWU CHEN
1370 BROOKLYN WALK NE #12.5
ISSAQUAH, WA 98029

SHWONEK ERIC+TAMI
1376 CHELSEA WALK NE
ISSAQUAH, WA 98029

FUKURA ROBERT F+DONNA F
1363 GREENWICH WALK NE
ISSAQUAH, WA 98029

HENDERSON EDWARD A+ANGELA A
1370 WILLIAMSBURG WALK NE
ISSAQUAH, WA 98029

YIN HUAZHE
1376 GREENWICH WALK NE
ISSAQUAH, WA 98029

NAGARAJA ANITHA+SUDHEENDRA
1364 WILLIAMSBURG WALK NE
ISSAQUAH, WA 98029

PONOMARENKO MYKHAILO
1371 BROOKLYN WALK NE
ISSAQUAH, WA 98029

TISONI YIT+OLIVIA SYLVIE-MA
1378 WILLIAMSBURG WALK NE
ISSAQUAH, WA 98029

ZENG YAN+SUN YIJING
1379 GREENWICH WK NE
ISSAQUAH, WA 98029

MOHAN HEMANT+NIRUPAMA SRINI
1387 BROOKLYN WALK NE
ISSAQUAH, WA 98029

YE DI+WANG YUNTIAN
1396 BROOKLYN WALK NE
ISSAQUAH, WA 98029

ARMFIELD REBECCA L
1380 CHELSEA WALK NE
ISSAQUAH, WA 98029

REN YING+LUO HEHUI
1388 BROOKLYN WALK NE
ISSAQUAH, WA 98029

AMERICA ANTI-AGING INSTITUT
1782 272ND AVE SE
SAMMAMISH, WA 98075

VERMA SUSHANT+NANCY KHANDUJ
1380 WILLIAMSBURG WALK NE
ISSAQUAH, WA 98029

MCLERAN AARON P+SARAH E SPE
1388 WILLIAMSBURG WALK NE
ISSAQUAH, WA 98029

LAI HUI WU
1782 272ND PL SE
SAMMAMISH, WA 98075

STARING JOHAN+EMMA
1382 CHELSEA WALK NE
ISSAQUAH, WA 98029

OVIATT MCKAY DARIN+VANESSA
1389 BROOKLYN WALK NE
ISSAQUAH, WA 98029

WESTRIDGE ISSAQUAH LP
19700 FAIRCHILD RD #260
IRVINE, CA 92612

TJAHJADY ADELA AGUNG
1382 WILLIAMSBURG WALK NE #21.
3
ISSAQUAH, WA 98029

JEON CHANG HOON+JUNG NAM KW
1390 BROOKLYN WALK NE
ISSAQUAH, WA 98029

KING COUNTY-TRANSIT
201 S JACKSON ST #417
SEATTLE, WA 98104

LI XIAOYE+YI SHA
1383 BROOKLYN WALK NE
ISSAQUAH, WA 98029

LIU HAIYANG+YI ZHANG
1391 BROOKLYN WALK NE
ISSAQUAH, WA 98029

BATTERMAN KASEY
211 LIBERTY ST #4
SAN FRANCISCO, CA 94114

HUBER TIM
1384 BROOKLYN WALK NE
ISSAQUAH, WA 98029

HAIGHT GARY+LINDA
1392 BROOKLYN WALK NE
ISSAQUAH, WA 98029

XUE MIN+ZHU LINGJIE
225 4TH AVE #A402
KIRKLAND, WA 98033

BOGOMOLNY ALEXANDER+VICTORI
1384 GREENWICH WALK NE
ISSAQUAH, WA 98029

DENG ZIRUI
1393 BROOKLYN WALK NE
ISSAQUAH, WA 98029

ZHU LINGJIE+XUE MIN
225 4TH AVE #A402
KIRKLAND, WA 98033

FLAJOLE BENJAMIN L+BRITTANY
1384 WILLIAMSBURG WALK NE
ISSAQUAH, WA 98029

YAP YEOW S
1394 BROOKLYN WALK N.E.
ISSAQUAH, WA 98029

AMERICAN ICHING INSTITUTE
22756 SE 32ND ST
SAMMAMISH, WA 98075

GUPTA VIKAS+SRISHTI MITTAL
1386 WILLIAMSBURG WALK NE
ISSAQUAH, WA 98029

GHOSH DEBAJIT+ROY ROMI -TTE
1395 BROOKLYN WALK NE
ISSAQUAH, WA 98029

LAI HUI WU
22756 SE 32ND ST
SAMMAMISH, WA 98075

LAI HUIWU
22756 SE 32ND ST
SAMMAMISH, WA 98075

SOEPRAJITNO WIWIEK AJINO+IS
357 NE DENNY WAY
ISSAQUAH, WA 98029

MA XI
387 NE EATON LN
ISSAQUAH, WA 98029

PENG XIANGHENG+SHI XIANSONG
24001 SE BLACK NUGGET RD
ISSAQUAH, WA 98029

DAI JINGXUAN
358 NE DARBY LN
ISSAQUAH, WA 98029

TUMUR-OCHIR SUKHBAT
390 NE DARBY LN
ISSAQUAH, WA 98029

YIN KANG+SHUIYUN LIU
2871 PINE VALLEY RD
SAN RAMON, CA 94583

SCAFIDI DAVID A
358 NE DENNY WAY
ISSAQUAH, WA 98029

MARS SHAUN M+JENNIFER R
398 NE DENNY WAY
ISSAQUAH, WA 98029

CABIAO REBECCA
3023 22ND AVE S
SEATTLE, WA 98144

CHUNG EUN+CHUNG UN
361 NE EATON LN
ISSAQUAH, WA 98029

SWART HEDI
428 289TH PL NE
CARNATION, WA 98014

TE HIGHLAND LLC
3143 HUNTS POINT RD
BELLEVUE, WA 98004

HARRELL STEVEN E+KATHRYN C
364 NE DARBY LN
ISSAQUAH, WA 98029

HUANG JUNG-CHING+SHU-HUEI H
4540 OLD OAK CT
PLYMOUTH, MI 48170

CHUNG SONG+JIHYUN KWON
333 NE DENNY WAY
ISSAQUAH, WA 98029

KIRSANOV PHILIPPE+ELLINA CH
365 NE DENNY WAY
ISSAQUAH, WA 98029

RAVIKUMAR GOVINDARAJ+PRAWVE
4730 231ST PL SE
SAMMAMISH, WA 98075

CAO JIE
334 NE DARBY LN
ISSAQUAH, WA 98029

ZHANG JIAN
370 NE EATON LN
ISSAQUAH, WA 98029

PITTMAN JOAN
6059 NE 61ST ST
SEATTLE, WA 98115

PHUNG HONG+SHIRLEY+MARK+SYL
339 NE DENNY WAY
ISSAQUAH, WA 98029

GVOZDEV VLADIMIR+EVGENIA GV
372 NE DENNY WAY
ISSAQUAH, WA 98029

SWEDISH HEALTH SERVICE
747 BROADWAY
SEATTLE, WA 98122

QIAN SONG
344 NE DENNY WAY
ISSAQUAH, WA 98029

ANSHU MISHRA+JHA
375 NE DENNY WAY
ISSAQUAH, WA 98029

DECKER TIA R
800 4TH AVE NE
ISSAQUAH, WA 98029

WENG JUN+ZHANG QIAN MING
347 NE DENNY WY
ISSAQUAH, WA 98029

PANICKER SURAJ+SARITHA NAIR
386 NE DENNY WAY
ISSAQUAH, WA 98029

BHOSALE PRADHUMNA K+SAYALI
803 4TH AVE NE
ISSAQUAH, WA 98029

SANDERSON ASHTON C+JASMINE
806 4TH AVE NE
ISSAQUAH, WA 98029

LEE MARK S+JENNIFER R
822 4TH AVE NE
ISSAQUAH, WA 98029

HARDEN JOHN P+NAMI
846 4TH AVE NE
ISSAQUAH, WA 98029

KHANAN IFFAT U
807 5TH PL NE
ISSAQUAH, WA 98029

SWANSON ROBERT J+KAREN E
826 4TH AVE NE
ISSAQUAH, WA 98029

DOBYNS DANIEL A+KRISTEN A
850 4TH AVE NE
ISSAQUAH, WA 98029

YU G
809 4TH AVE NE
ISSAQUAH, WA 98029

BROWN FLETCHER JR
827 5TH PL NE
ISSAQUAH, WA 98029

WHITING WILLIAM+AMANDA
851 5TH PL NE
ISSAQUAH, WA 98029

SHELFHORSE STACY E
810 4TH AVE NE
ISSAQUAH, WA 98029

WATSON EDWARD
830 4TH AVE NE
ISSAQUAH, WA 98029

VAIDYANATH SREERAM+SHARMADH
853 4TH AVE NE
ISSAQUAH, WA 98029

MORRISON JASON
811 5TH PL NE
ISSAQUAH, WA 98029

MILES CASEY J
831 5TH PL NE
ISSAQUAH, WA 98029

RYSTENKO ANDRII
856 4TH AVE NE
ISSAQUAH, WA 98029

HE HUAN
813 4TH AVE NE
ISSAQUAH, WA 98029

TALLEGAS VERONIQUE
834 4TH AVE NE
ISSAQUAH, WA 98029

HONG SOONHYUNG+JOOWON
857 4TH AVE NE
ISSAQUAH, WA 98029

EUBANKS JOSHUA M+MIWAKO
814 4TH AVE NE
ISSAQUAH, WA 98029

COREY JAMES
838 4TH AVE NE
ISSAQUAH, WA 98029

CATTELL JASON M
857 5TH PL NE
ISSAQUAH, WA 98029

BOBBIO GUSTAVO A+ROXANA GUE
818 4TH AVE NE
ISSAQUAH, WA 98029

JENSEN ELISHA+DAUGHERTY JAR
841 5TH PL NE
ISSAQUAH, WA 98029

RUSSELL CHRISTOPHER J+ELIZA
859 4TH AVE NE
ISSAQUAH, WA 98029

HAO HE
819 5TH PL NE
ISSAQUAH, WA 98029

NAJAVITS JUDITH P
842 4TH AVE NE
ISSAQUAH, WA 98029

KARAFEZOV NIKOLAY+ZHASMINA
860 4TH AVE NE
ISSAQUAH, WA 98029

MILLAS CATALINA A+ELIZABETH
821 5TH PL NE
ISSAQUAH, WA 98029

LEON RYAN+BREANNA
843 5TH PL NE
ISSAQUAH, WA 98029

CHENG JEFFREY JONATHAN+GOE
861 4TH AVE NE
ISSAQUAH, WA 98029

HAYS WILLIAM B+HAYS KATHERI
863 4TH AVE NE
ISSAQUAH, WA 98029

LABUGUEN JOEL F+NANCY
877 5TH PL NE
ISSAQUAH, WA 98029

GONZALVO ERMIN J+DUQUE CATH
908 4TH AVE NE
ISSAQUAH, WA 98029

ELNABLY AHMED ABDELRAHMAN
865 4TH AVE NE
ISSAQUAH, WA 98029

LEE MI H
878 4TH AVE NE
ISSAQUAH, WA 98029

JIANG ZHOUQIAN+ZHOU YI
908 STRAFFORD CT
STATE COLLEGE, PA 16801

THORSON CONNIE L
867 5TH PL NE
ISSAQUAH, WA 98029

CHANG STEWART T+YUKO KAWABA
879 4TH AVE NE
ISSAQUAH, WA 98029

FROST JOSHUA J+ELIZABETH M
913 5TH PL NE
ISSAQUAH, WA 98029

LEVY MARTIN D+JOEY K+CALVO
869 4TH AVE NE
ISSAQUAH, WA 98029

ZHANG YIXUN
881 5TH PL NE
ISSAQUAH, WA 98029

TU JIMMY
916 4TH AVE NE
ISSAQUAH, WA 98029

TREMBLAY CYNTHIA A
870 3RD AVE NE
ISSAQUAH, WA 98029

CROW LLIANA+JEFFRY
883 4TH AVE NE
ISSAQUAH, WA 98029

ISSAQUAH HIGHLANDS SS
918 S HORTON ST #1000
SEATTLE, WA 98134

CAO YIMING+YUE DAI
871 4TH AVE NE
ISSAQUAH, WA 98029

PARK GRACE
885 5TH PL NE
ISSAQUAH, WA 98029

ISSAQUAH HIGHLANDS SELF STO
918 S HORTON ST STE 1000
SEATTLE, WA 98134

RISTIC ANNA
871 5TH PL NE
ISSAQUAH, WA 98029

DONG FANG+LIU XUHUI
900 4TH AVE NE
ISSAQUAH, WA 98029

NG ALBERT+ANGEL
922 144TH AVE NE
BELLEVUE, WA 98007

MARCHIONE MICHAEL J+CHRISTI
872 4TH AVE NE
ISSAQUAH, WA 98029

CLOUSE GREGORY+KAREN
901 5TH PL NE
ISSAQUAH, WA 98029

SHAAR AMEENA
923 NE ELLIS DR #20.1
ISSAQUAH, WA 98029

SANTO KAREN A+ROWNTREE JAME
874 4TH AVE NE
ISSAQUAH, WA 98029

FINK MELANIE & MICHAEL
9012 SE 50TH ST
MERCER ISLAND, WA 98040

ZHANG QIANQIAN+FENG CHAO
925 NE ELLIS DR
ISSAQUAH, WA 98029

MULLOY GALINA I
875 4TH AVE NE
ISSAQUAH, WA 98029

HARTONO BENNY+OLIVIA BUDHIO
905 4TH AVE NE
ISSAQUAH, WA 98029

IM CHIHYE R+YONG-HWAN CHEE
927 5TH PL NE
ISSAQUAH, WA 98029

PHAM LIEM T+HONG T L VO
927 NE ELLIS DR
ISSAQUAH, WA 98029

XU CHENGCAI+LI XUE
970 NE DISCOVERY DR
ISSAQUAH, WA 98029

ISSAQUAH CITY OF PARKS
PO BOX 1307
ISSAQUAH, WA 98027

ORTIZ ABIMAEL+SONYA
929 NE ELLIS DR
ISSAQUAH, WA 98029

LEE HAN+HYE Y JUNG
971 NE ELLIS DR #5-2
ISSAQUAH, WA 98029

COLE JUDY
PO BOX 1714
ISSAQUAH, WA 98027

CHATURVEDI AMIT+ABHILASHA B
931 NE ELLIS DR
ISSAQUAH, WA 98029

GOPINATHA ANOOP K
974 NE DISCOVERY DRIVE
ISSAQUAH, WA 98029

SWEDISH HEALTH SERVICES
PO BOX 24883
SEATTLE, WA 98124

HINKLEY FRANK W+LOYA GILLIA
933 NE ELLIS DR
ISSAQUAH, WA 98029

GUYTON ROBERT M+TATIANA V
974 NE DISCOVERY DR
ISSAQUAH, WA 98029

LAKESIDE INDUSTRIES
PO BOX 7016
ISSAQUAH, WA 98027

BLAIR RICHARD ALLEN+LESLIE
935 NE ELLIS DR
ISSAQUAH, WA 98029

MYETTE SUSAN R+PFEIFFER DAN
975 NE DISCOVERY DR #301
ISSAQUAH, WA 98029

GRAND RIDGE PLAZA II LLC
PO BOX 790830
SAN ANTONIO, TX 78279

HE YING
937 NE ELLIS DR
ISSAQUAH, WA 98029

SWAMINATHAN SAIVIVEKH+PRATH
975 NE ELLIS DR
ISSAQUAH, WA 98029

BACKSTROM KATHERINE N
PO BOX 94786
SEATTLE, WA 98124

UTZ JAMES E+LISA J
939 NE ELLIS DR
ISSAQUAH, WA 98029

KRISHNAN SUDARSANAN
976 NE DISCOVERY DR
ISSAQUAH, WA 98029

WOLFE LARA
941 5TH PL NE
ISSAQUAH, WA 98029

YADAV ATENDRA S+NEELAM
977 NE ELLIS DR #5.4
ISSAQUAH, WA 98029

STRATTON SCOTT W
941 NE ELLIS DR
ISSAQUAH, WA 98029

OHASHI KAZUKO
981 NE ELLIS DR
ISSAQUAH, WA 98029

SHANNON ANNE M
969 NE ELLIS DR UNIT 5-1
ISSAQUAH, WA 98029

ISSAQUAH CITY OF
PO BOX 1307
ISSAQUAH, WA 98027