

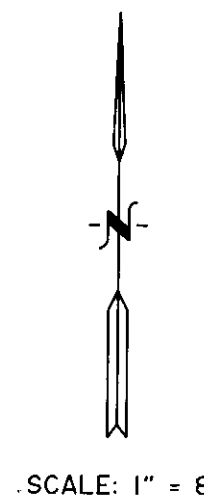

# ALDER STREET TOWNHOMES, A CONDOMINIUM

SECOND FLOOR

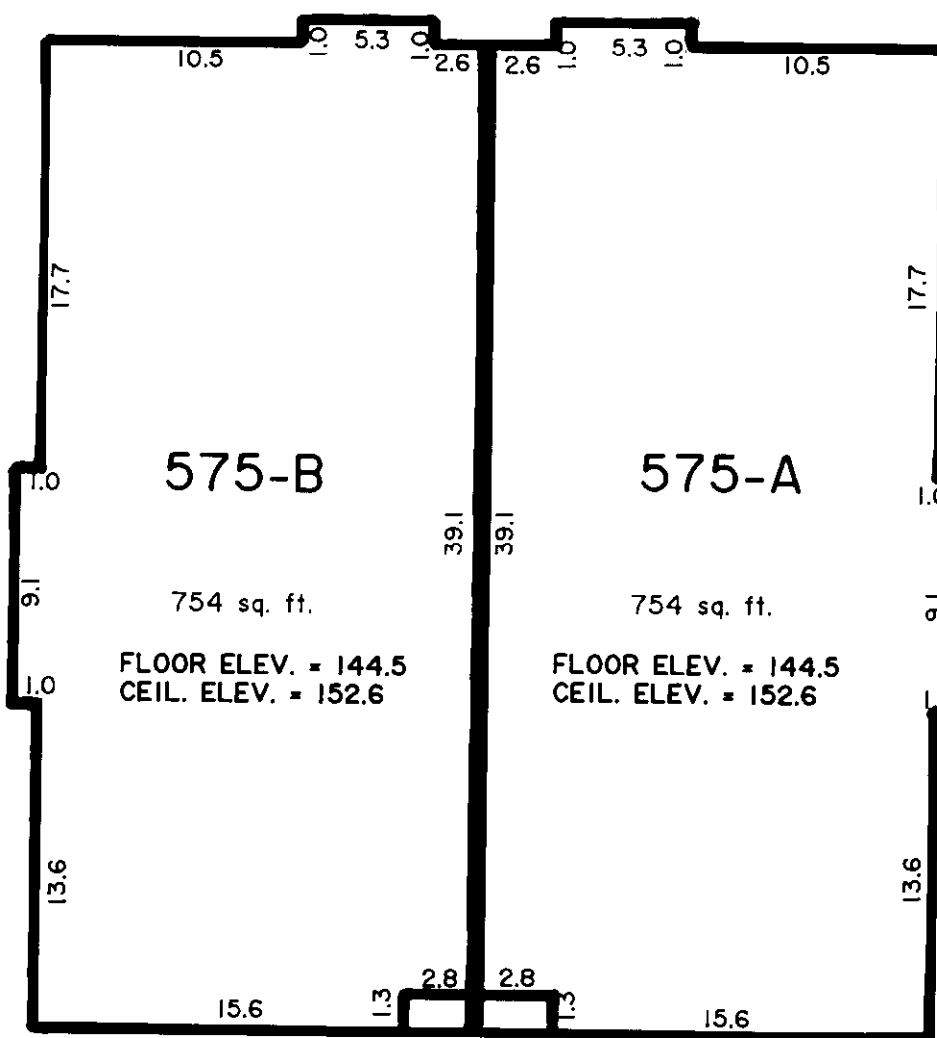
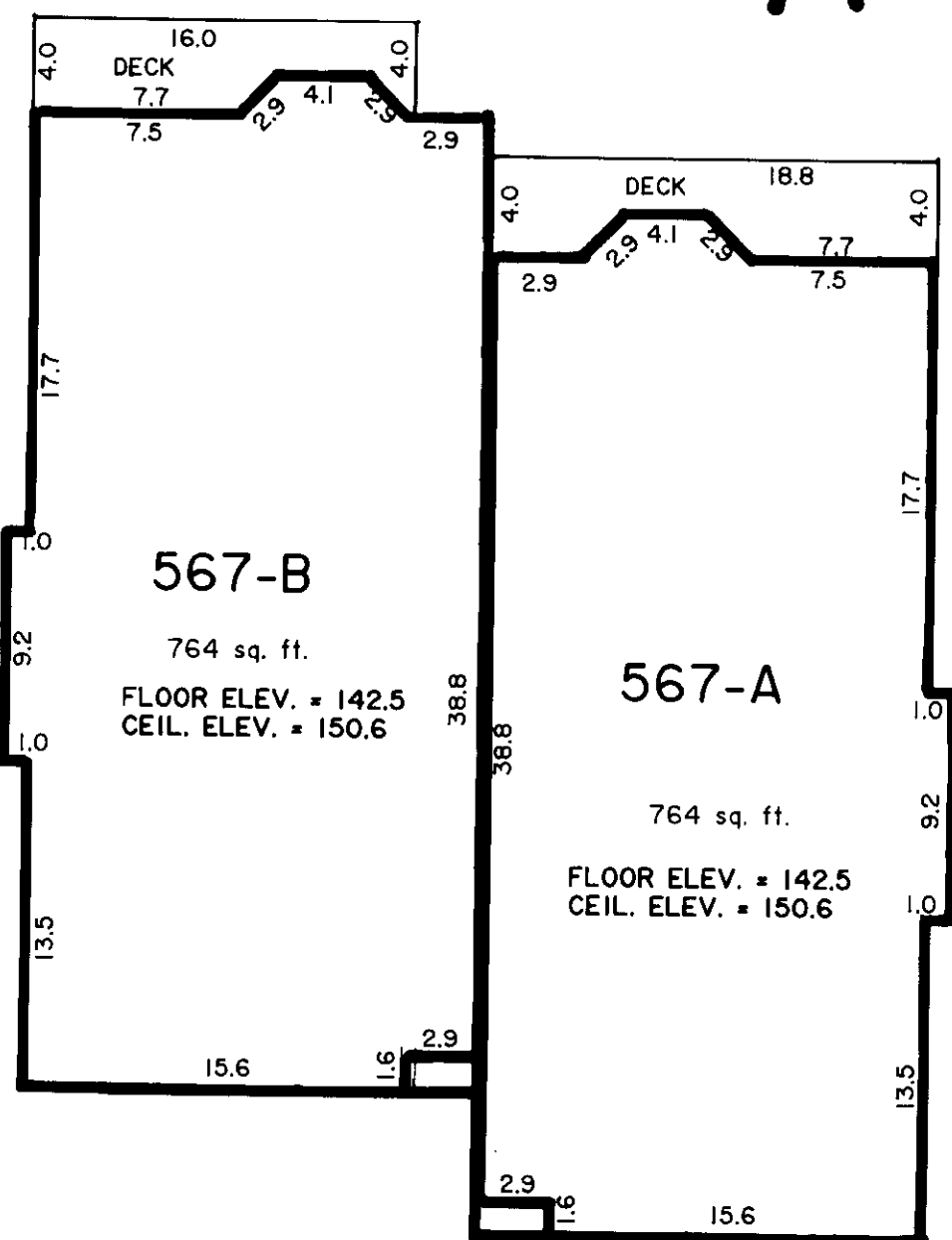

SECOND FLOOR

FIRST FLOOR

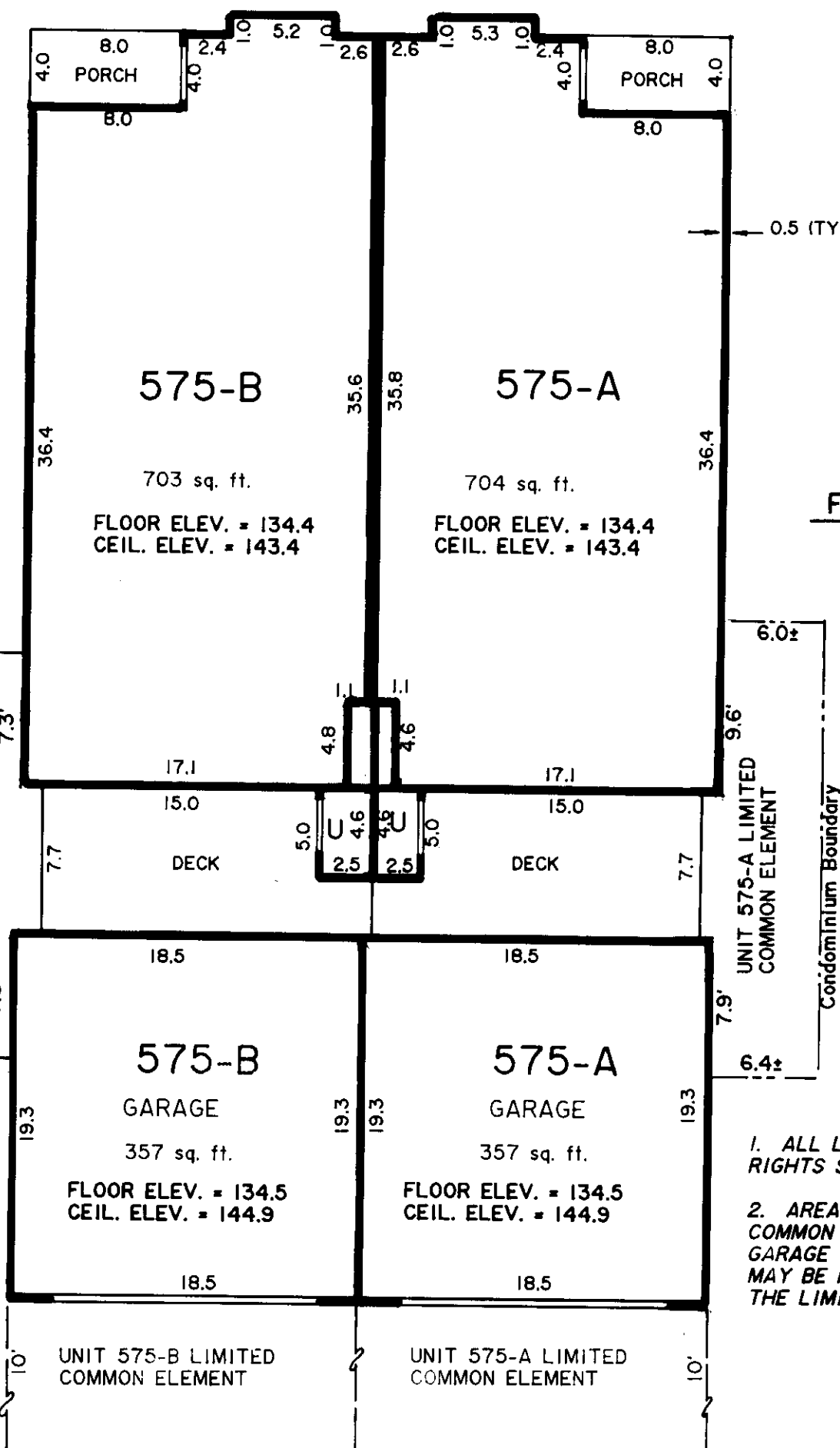
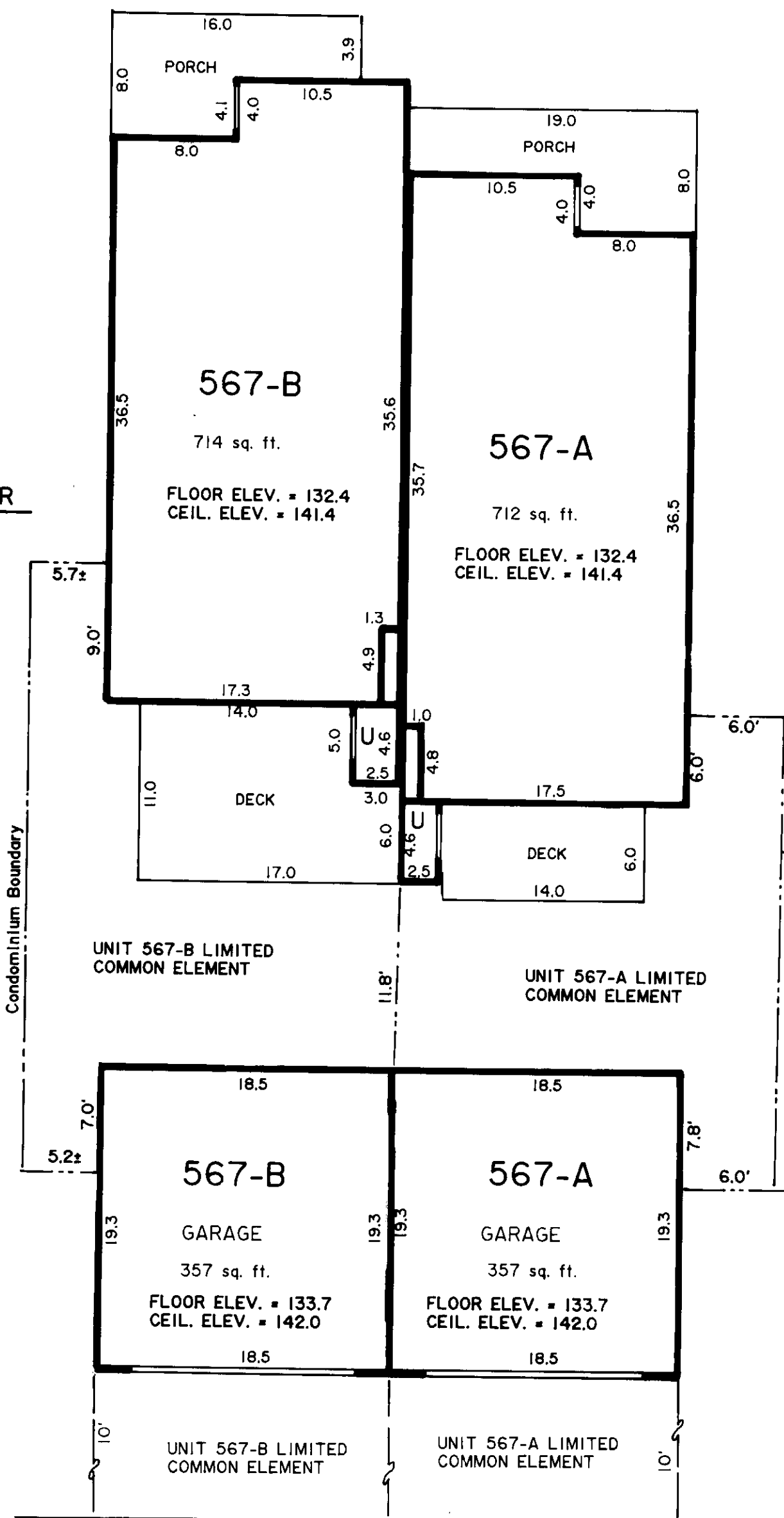

FIRST FLOOR

U DENOTES UTILITY ROOM  
(FURNACE & WATER HEATER)

NOTE

1. ALL LAND IS SUBJECT TO DEVELOPMENT RIGHTS SET FORTH IN THE DECLARATION.
2. AREA IN FRONT OF GARAGE IS A LIMITED COMMON ELEMENT FOR UNIT TO WHICH GARAGE IS ALLOCATED. NO MOTOR VEHICLE MAY BE PARKED OUTSIDE THE BOUNDARY OF THE LIMITED COMMON ELEMENT.

SOUTH PROPERTY LINE

SHEET 2 OF 2