

ISSAQUAH COURT A CONDOMINIUM

SECTION 28, TOWNSHIP 24 NORTH, RANGE 6 EAST, W.M.
CITY OF ISSAQUAH COUNTY OF KING STATE OF WASHINGTON

LEGAL DESCRIPTION

THAT PORTION OF THE SOUTHEAST QUARTER OF SECTION 28, TOWNSHIP 24 NORTH, RANGE 6 EAST, W.M., IN KING COUNTY, WASHINGTON, DESCRIBED AS FOLLOWS:

BEGINNING AT A POINT 214.5 FEET WEST AND 589 FEET NORTH OF THE SOUTHEAST CORNER OF SAID SECTION 28;
THENCE NORTH 128 FEET;
THENCE WEST 165 FEET;
THENCE SOUTH 128 FEET
THENCE EAST 165 FEET TO THE TRUE POINT OF BEGINNING;

EXCEPT THE EAST 7.50 FEET AND EXCEPT THE WEST 8.50 FEET THEREOF AS CONVEYED TO THE CITY OF ISSAQUAH FOR PUBLIC ROADWAYS AND RIGHTS OF WAY BY STATUTORY WARRANTY DEED RECORDED UNDER KING COUNTY RECORDING NO: 9812292311, ~~RECORDED AS A~~
CORRECTED STATUTORY DEED UNDER KING COUNTY RECORDING NUMBER 9901301523.

DEDICATION

WE, THE UNDERSIGNED OWNER OR OWNERS OF THE INTEREST IN THE REAL PROPERTY DESCRIBED HEREIN, HEREBY DECLARE THIS SURVEY MAP AND PLANS AND DEDICATE THE SAME FOR A CONDOMINIUM SOLELY TO MEET THE REQUIREMENTS OF THE WASHINGTON CONDOMINIUM ACT, RCW 64.34., ET SEQ., AND NOT FOR ANY PUBLIC PURPOSES.

WE FURTHER CERTIFY THAT ALL STRUCTURAL COMPONENTS AND MECHANICAL SYSTEMS OF ALL BUILDINGS CONTAINING OR COMPRISING ANY UNITS HEREBY CREATED ARE SUBSTANTIALLY COMPLETED.

THIS SURVEY MAP AND THESE PLANS AND ANY PORTION THEREOF ARE RESTRICTED BY LAW AND THE DECLARATION FOR ISSAQUAH COURT, A CONDOMINIUM, RECORDED UNDER KING COUNTY RECORDING NO. ~~20001031000319~~

ISSAQUAH COURT, INC.
A WASHINGTON CORPORATION

BY: Richard O. Wagner
ITS PRESIDENT

ACKNOWLEDGMENT

STATE OF WASHINGTON
COUNTY OF KING

I CERTIFY THAT I KNOW OR HAVE SATISFACTORY EVIDENCE THAT RICHARD O. WAGNER SIGNED THIS INSTRUMENT, ON OATH STATED THAT HE WAS AUTHORIZED TO EXECUTE THE INSTRUMENT AND ACKNOWLEDGED IT AS THE PRESIDENT OF ISSAQUAH COURT, INC., A WASHINGTON CORPORATION, TO BE THE FREE AND VOLUNTARY ACT OF SUCH CORPORATION FOR THE USES AND PURPOSES MENTIONED IN THE INSTRUMENT.

DATED THIS 12 DAY OF Oct, 2000.

PRINTED NAME John E. Hanson
NOTARY PUBLIC IN AND FOR THE STATE OF WASHINGTON,

RESIDING AT Bellevue

EXPIRATION DATE 12.31.01

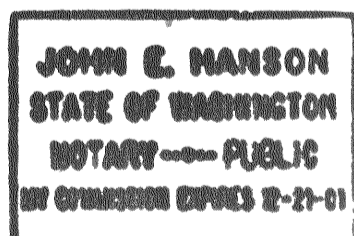

ASSESSOR'S CERTIFICATE

EXAMINED AND APPROVED THIS 30th DAY OF October, 2000.

Scott Noble
KING COUNTY ASSESSOR

by Debra Clark
DEPUTY KING COUNTY ASSESSOR

RECORDER'S CERTIFICATE 2000/03/000398

FILED FOR RECORD AT THE REQUEST OF ISSAQUAH COURT, INC., THIS 31st DAY OF Oct, 2000, AT 9:34 A.M. AND RECORDED IN VOLUME 163 OF CONDOMINIUMS, PAGES 48-49, RECORDS OF KING COUNTY, WASHINGTON.

DIVISION OF RECORDS AND ELECTIONS

Bob Bruce
MANAGER

W. T. Washington
SUPERINTENDENT OF RECORDS

SURVEYOR'S CERTIFICATE

I HEREBY CERTIFY THAT THIS SURVEY MAP AND PLANS OF ISSAQUAH COURT, A CONDOMINIUM, IS BASED UPON AN ACTUAL SURVEY OF THE PROPERTY DESCRIBED HEREIN; THAT THE COURSES AND BEARINGS ARE SHOWN CORRECTLY HEREIN; THAT ALL INFORMATION REQUIRED BY RCW 64.34.232 IS SUPPLIED HEREIN; AND THAT ALL HORIZONTAL AND VERTICAL BOUNDARIES OF THE UNITS ARE SUBSTANTIALLY COMPLETED IN ACCORDANCE WITH SAID PLANS.

Timothy E. Hanson
TIMOTHY E. HANSON
PROFESSIONAL LAND SURVEYOR
CERTIFICATE NO. 18903
DATE Aug. 31, 2000

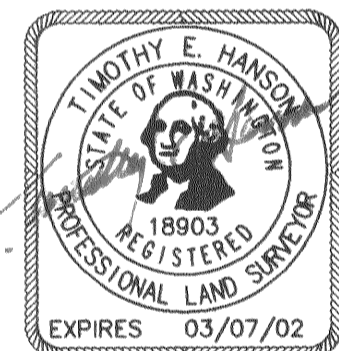

SURVEYOR'S VERIFICATION

STATE OF WASHINGTON
COUNTY OF KING

TIMOTHY E. HANSON, BEING FIRST ON OATH DULY SWORN, STATES THAT HE IS THE PROFESSIONAL LAND SURVEYOR SIGNING THE ABOVE CERTIFICATE, AND THAT HE BELIEVES THE ABOVE CERTIFICATE TO BE A TRUE STATEMENT.

Timothy E. Hanson
TIMOTHY E. HANSON
PROFESSIONAL LAND SURVEYOR
CERTIFICATE NO. 18903

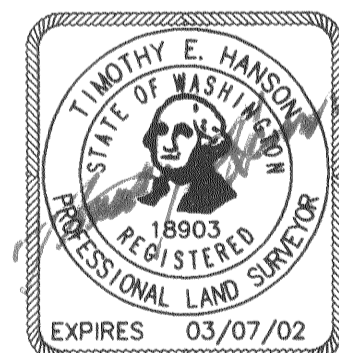

SUBSCRIBED AND SWORN TO BEFORE ME THIS 31 DAY OF

August, 2000.

Timothy E. Hanson
NOTARY PUBLIC IN AND FOR THE STATE OF WASHINGTON,

RESIDING AT Bellevue

EXPIRATION DATE 1/21/03

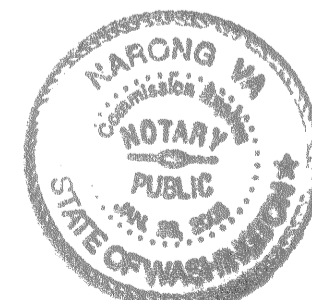

TIM HANSON AND ASSOCIATES, INC.

6025 - 108th AVENUE N.E. KIRKLAND, WA 98033
(425) 822-7271

169
45