

# ISSAQUAH COURT A CONDOMINIUM

SECTION 28, TOWNSHIP 24 NORTH, RANGE 6 EAST, W.M.  
CITY OF ISSAQUAH COUNTY OF KING STATE OF WASHINGTON

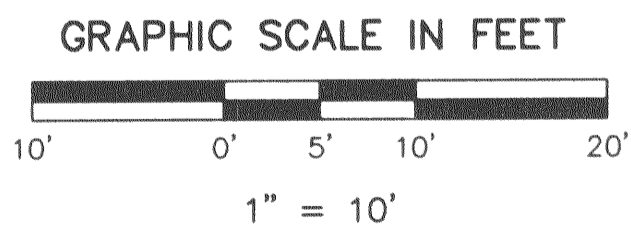

**FIRST FLOOR PLAN  
COMMERCIAL UNITS AND PARKING LEVEL**

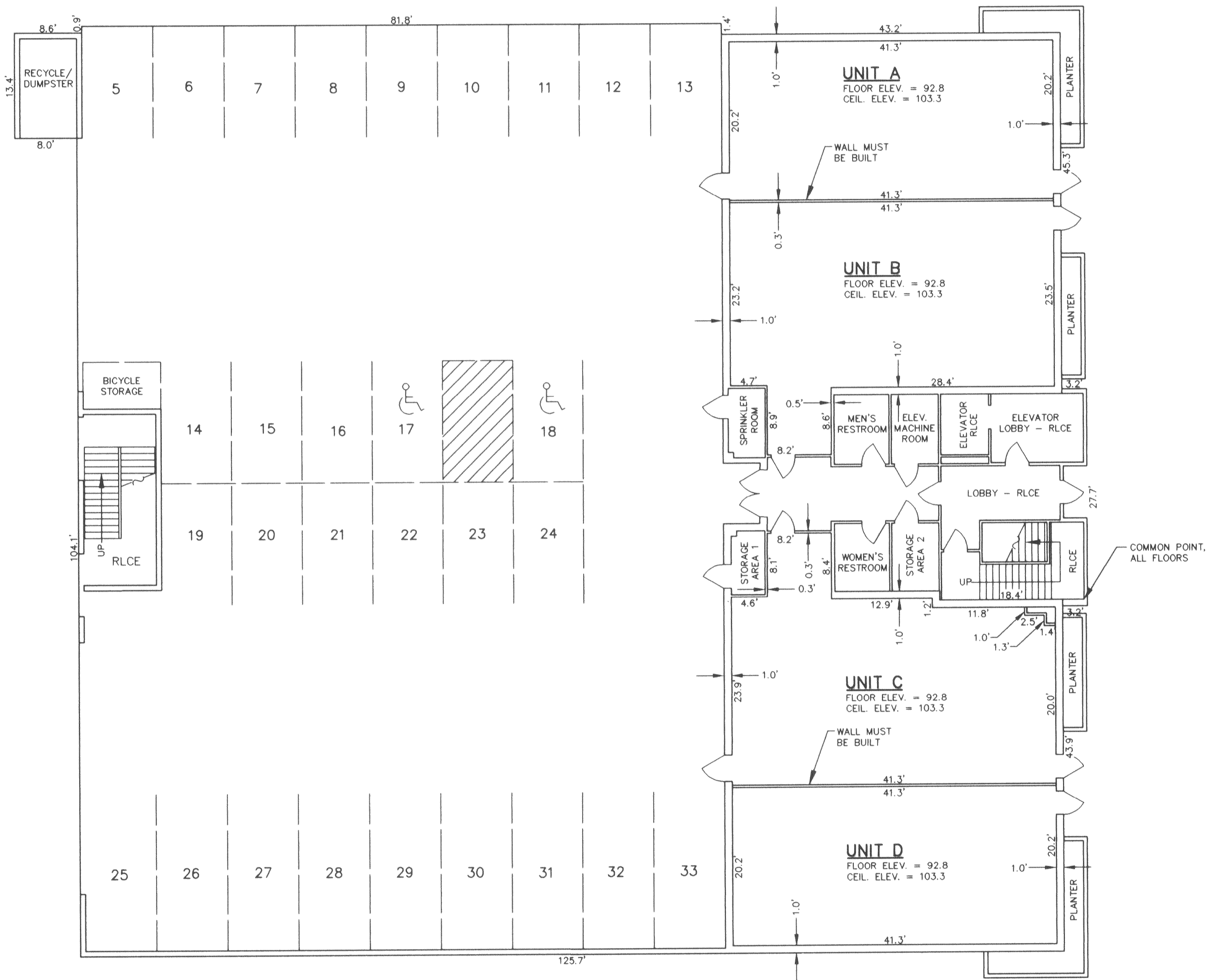
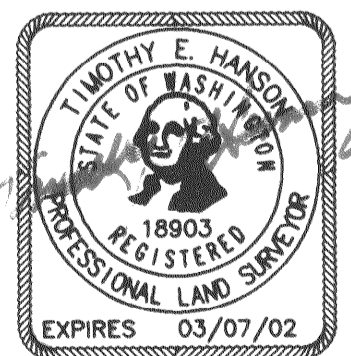

**TIM HANSON AND ASSOCIATES, INC.**  
6025 - 108th AVENUE N.E. KIRKLAND, WA 98033  
(425) 822-7271

5

69