

213/009

MONOHON CONDOMINIUM

SE 1/4, SW 1/4, SEC. 18, TWP. 24 N., RGE. 6 E, W.M., ISSAQUAH, KING COUNTY, WASHINGTON

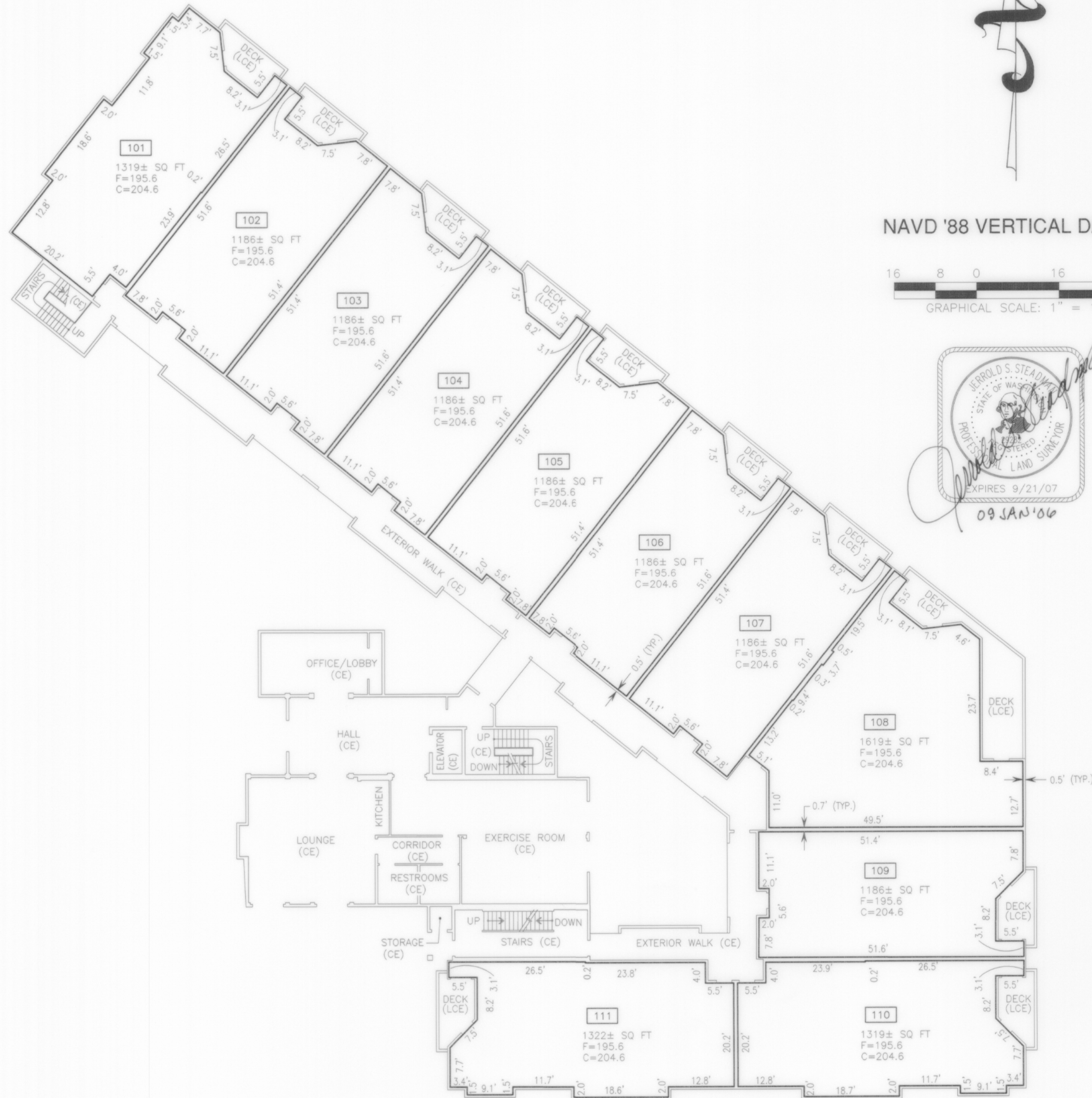

1ST FLOOR

**CONDOMINIUM
SURVEY COMPANY**

Specializing in

CONDOMINIUM SURVEYS ONLY

6564 FIFTH AVENUE SOUTH, SEATTLE, WASHINGTON 98108 (206) 762-3316

**CONDOMINIUM
SURVEY
MAP & PLANS**

SE 1/4, SW 1/4, SEC. 18,
TWP. 24 N., RGE. 6 E., W.M.,
KING COUNTY, WASHINGTON

INDEX

2005-003.00

DATE: 17 MAY 2005

REVISED: 5 JANUARY 2006

DRAWN BY: MAM

MAP CHECK: JSS

FINAL CHECK: JSS

SHEET 4 OF 7