

213/010

MONOHON CONDOMINIUM

SE 1/4, SW 1/4, SEC. 18, TWP. 24 N., RGE. 6 E, W.M., ISSAQUAH, KING COUNTY, WASHINGTON

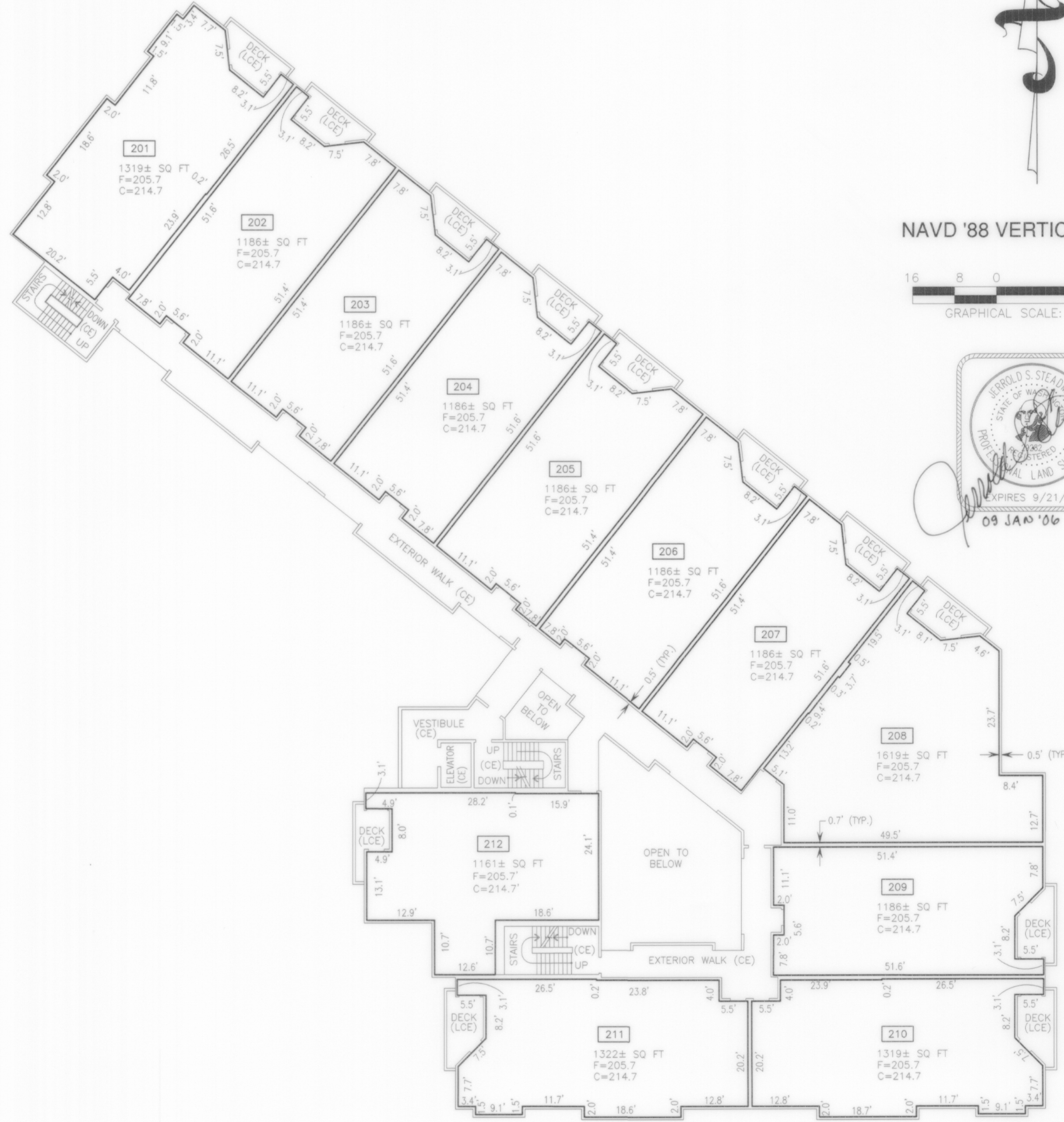

NAVD '88 VERTICAL DATUM

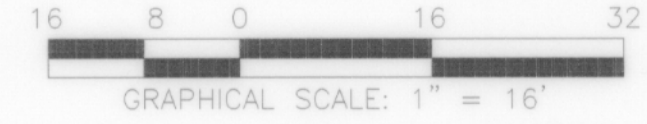

2ND FLOOR

**CONDOMINIUM
SURVEY COMPANY**

Specializing in
CONDOMINIUM SURVEYS ONLY
6564 FIFTH AVENUE SOUTH, SEATTLE, WASHINGTON 98108 (206) 762-3316

**CONDOMINIUM
SURVEY
MAP & PLANS**

SE1/4, SW1/4, SEC. 18,
TWP. 24 N., RGE. 6 E., W.M.
KING COUNTY, WASHINGTON

INDEX

2005-003.00

DATE: 17 MAY 2005
 REVISED: 1 SEPTEMBER 2005
 DRAWN BY: MAM
 MAP CHECK: MAM
 FINAL CHECK: JSS
 SHEET 5 OF 7