

Newport Woods Condominiums

NW 1/4, SE 1/4, SEC. 28, TWP. 24 N., RGE. 6 E., W.M., KING COUNTY, WASHINGTON

LEGEND

- 1103 UNIT DESIGNATION
- C.E. COMMON ELEMENT
- L.C.E. LIMITED COMMON ELEMENT
- F = FLOOR ELEVATION
- C = CEILING ELEVATION

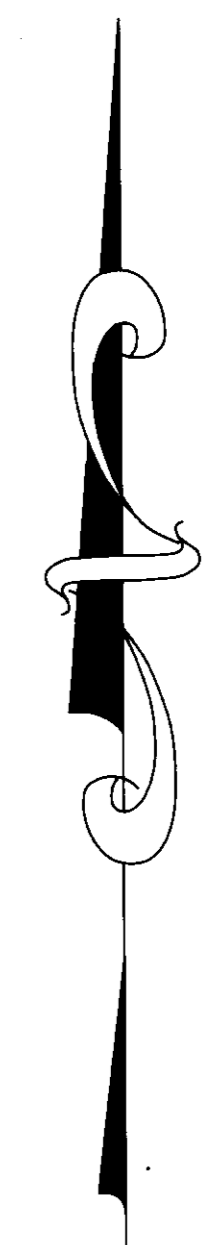
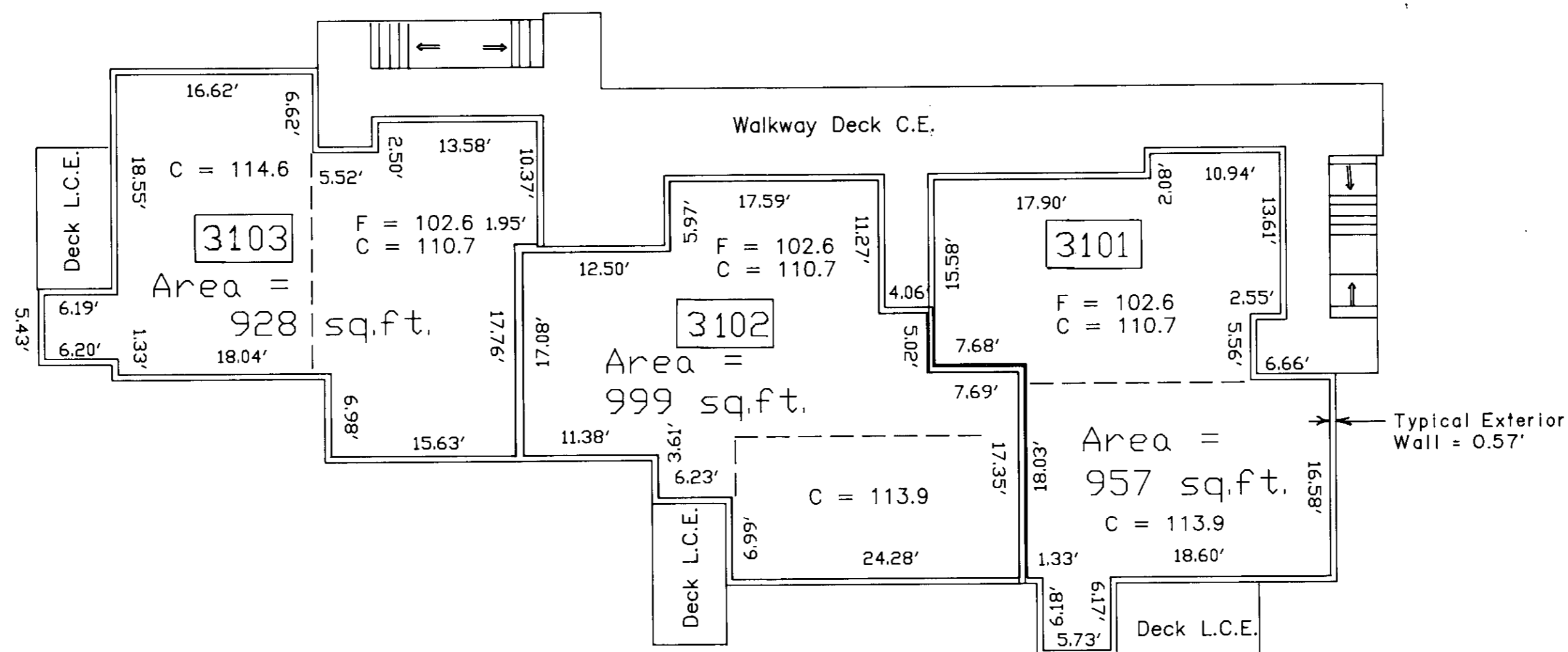
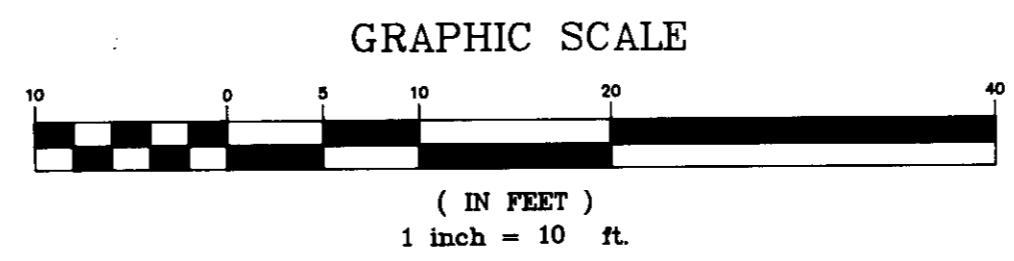

Third Floor

SCHROETER LAND SURVEYING PROFESSIONAL LAND SURVEYORS <small>P.O. Box 813, Seahurst, Washington 98062 (206) 242-6621 FAX (206)243-9679</small>			SURVEY FOR: Kenicer, Cozzetto, Serene Village Associates c/o Winton & Associates, Inc. 15245 Pacific Highway So. Suite L-2 Seattle, Washington 98188
PROJECT NO. 96096	JOB NO.	SEC.	
DATE FIELD	DWN BY low	CHKD. BY	
DATE 12/20/96	SCALE 1" = 10'	SHEET 5 OF 5	