

- NOTES:
1. BASIS OF BEARINGS IS THE WASHINGTON STATE COORDINATE SYSTEM, N.A.D. 1983/91, NORTH ZONE, AS ESTABLISHED BY THE KING COUNTY CONTROL NETWORK.
 2. THIS EXHIBIT IS BASED ON RECORD INFORMATION AND IS NOT A FIELD SURVEY.
 3. THE UNDERLYING PHOTO IS PROVIDED BY BING MAPS FOR REFERENCE ONLY. THE LOCATION IS ONLY APPROXIMATE.
 4. THE HEREIN DESCRIBED LEGAL DESCRIPTION IS PROVIDED BY FIRST AMERICAN TITLE INSURANCE COMPANY, ORDER NO. NCS-962971-WA1 DATED MAY 29, 2019 AT 7:30 AM.
 5. THE FOLLOWING RECORD INFORMATION WAS USED IN PREPARING THIS EXHIBIT.
 - A) RECORD OF SURVEY PER RECORDING NUMBER 7501070413.
 - B) BOUNDARY LINE ADJUSTMENT PER RECORDING NUMBER 950809007.
 - C) KING COUNTY SURVEY CONTROL NETWORK.
 - D) BING MAPS.

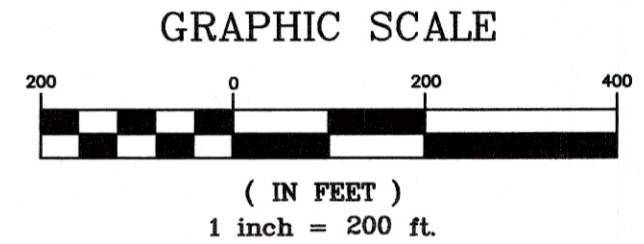

LEGAL DESCRIPTION:

PARCEL A:
 A STRIP OF LAND 40 FEET WIDE THROUGH THE SOUTHWEST QUARTER OF THE NORTHWEST QUARTER OF SECTION 21, TOWNSHIP 24 NORTH, RANGE 6 EAST, W.M., IN KING COUNTY, WASHINGTON, THE CENTER LINE OF WHICH BEGINS ON THE SOUTH LINE OF SAID TRACT, 495 FEET WEST OF THE SOUTHEAST CORNER THEREOF;
 RUNNING THENCE NORTH 1°19'34" WEST 388 FEET;
 THENCE NORTH 37°09'26" WEST 1195 FEET TO A POINT ON THE NORTH LINE OF SAID TRACT, 90 FEET EAST FROM THE NORTHWEST CORNER THEREOF;

EXCEPT ANY PORTION THEREOF LYING WITHIN SOUTHWEST SAMMAMISH ROAD.

PARCEL B:
 A STRIP OF LAND 40 FEET WIDE THROUGH THE NORTHWEST QUARTER OF THE NORTHWEST QUARTER OF SECTION 21, TOWNSHIP 24 NORTH, RANGE 6 EAST, W.M., IN KING COUNTY, WASHINGTON, THE CENTER LINE OF WHICH BEGINS ON THE SOUTH LINE OF SAID TRACT, 80 FEET EAST OF THE SOUTHWEST CORNER THEREOF;
 THENCE NORTH 37°09'26" WEST 100 FEET TO A POINT ON THE WEST LINE OF SAID TRACT 1118 FEET NORTH OF THE SOUTHWEST CORNER THEREOF.

PARCEL C:
 A STRIP OF LAND 40 FEET WIDE THROUGH THE NORTHEAST QUARTER OF THE NORTHEAST QUARTER OF SECTION 20, TOWNSHIP 24 NORTH, RANGE 6 EAST, W.M., IN KING COUNTY, WASHINGTON, THE CENTER LINE OF WHICH BEGINS ON THE EAST LINE OF SAID TRACT 118 FEET NORTH OF THE SOUTHEAST CORNER THEREOF;
 RUNNING THENCE NORTH 37°09'26" WEST 1012 FEET AND THE TERMINUS OF SAID STRIP OF LAND.

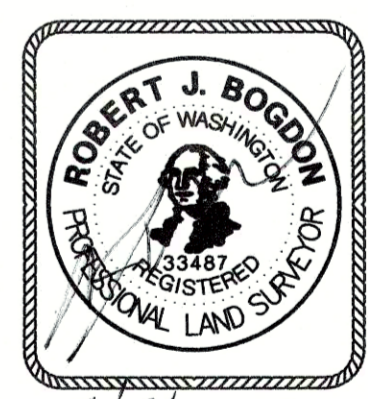

4/6/2020

**DRAINAGE TRACT EXHIBIT
 FOR THE CITY OF ISSAQUAH
 NE1/4 SEC. 20 & NW1/4 SEC. 21, T.24N., R.6E., W.M.
 KING COUNTY WASHINGTON**

DWN BY	DATE	JOB NO.
S. KITZ	4/2020	20040
CHKD BY	SCALE	SHEET
R. BOGDON	1"=200'	1 OF 1

EASTSIDE CONSULTANTS, INC.
 ENGINEERS-SURVEYORS
 1320 N.W. MALL ST., SUITE B
 ISSAQUAH, WASHINGTON 98027
 PHONE: (425)392-5351
 FAX: (425)392-4676

WEST 1/4 COR.
 SEC. 20-24-6
 RECORD POSITION PER
 KING COUNTY CONTROL
 NETWORK

WEST 1/4 COR.
 SEC. 21-24-6
 CALC. POSITION PER
 R.O.S. 7501070413

EAST 1/4 COR.
 SEC. 21-24-6
 RECORD POSITION PER
 KING COUNTY CONTROL
 NETWORK