

Lawrence S. Braund, P.E.

Thomas A. Johnson, AIA

Greg L. Allwine, Arch.

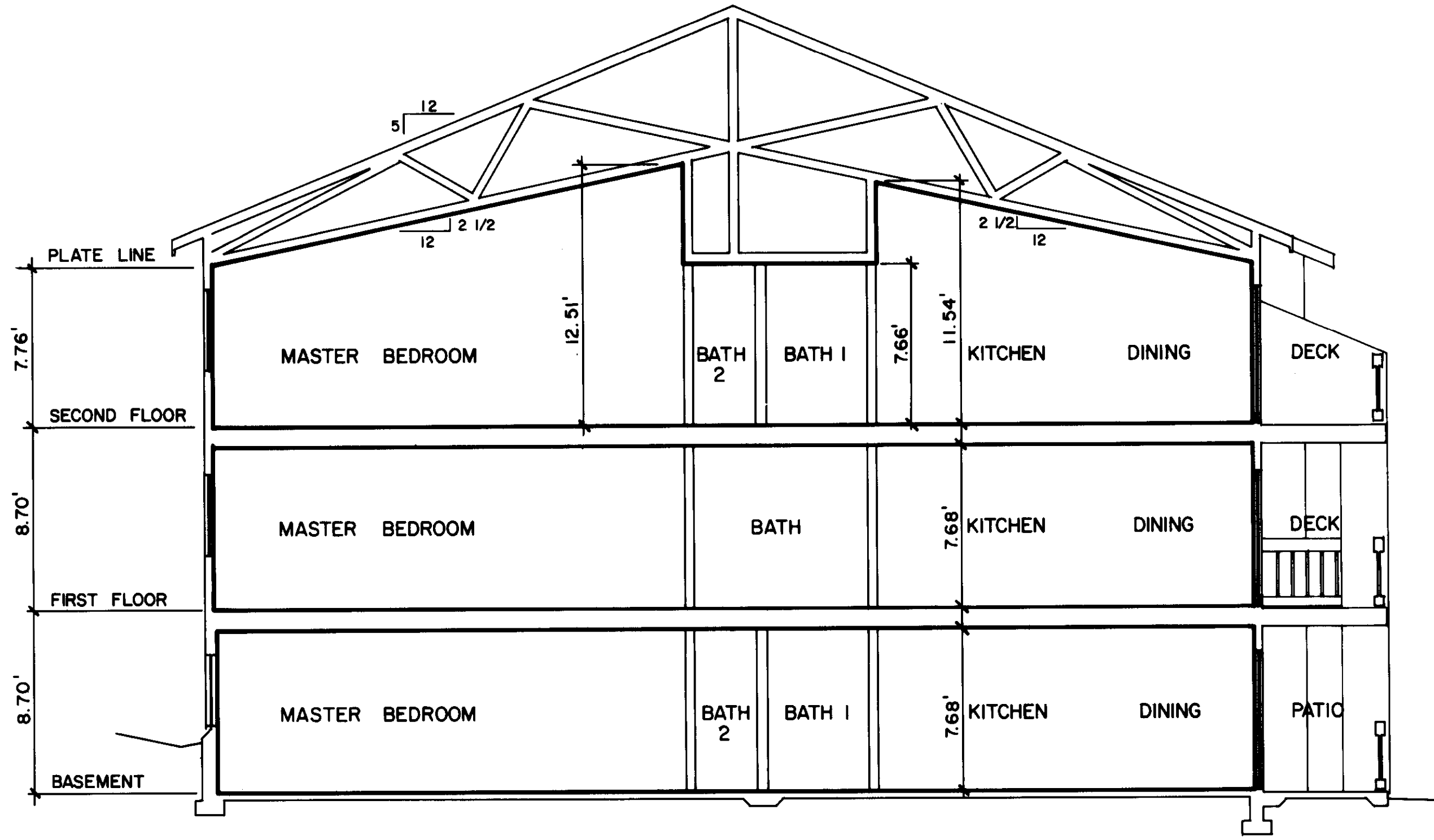

3A
3HC (3A SIMILAR)
3A

BUILDING SECTION A-A
3/16" = 1'-0"

**RIDGEBROOK
A CONDOMINIUM**

Project No : 82-16

Drawn by :

Issue date : 15 APR '69

Latest rev. :

304 main ave. so., suite 200 renton, wa. 98055 (206) 271-7200 623-5732