

THE VILLAGE AT MONTREUX A CONDOMINIUM - PHASE I

SITUATE IN THE NW 1/4 OF SEC. 19, TWP. 24 N., R. 6 E., W.M.,
CITY OF ISSAQUAH, KING COUNTY, WASHINGTON

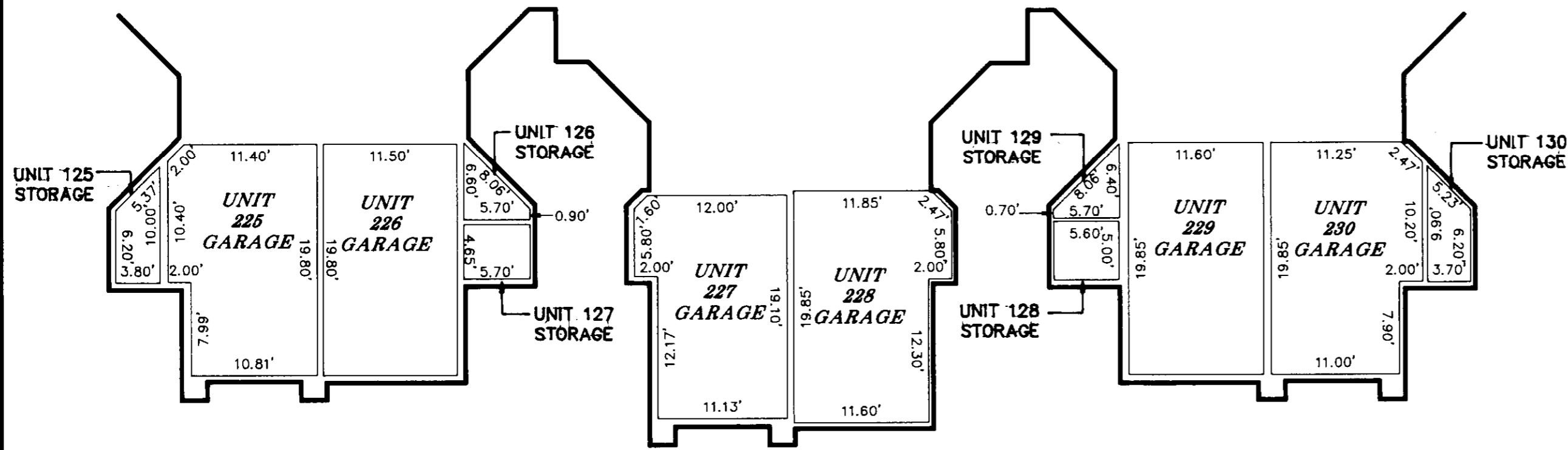

BUILDING E GARAGES AND STORAGE AREAS

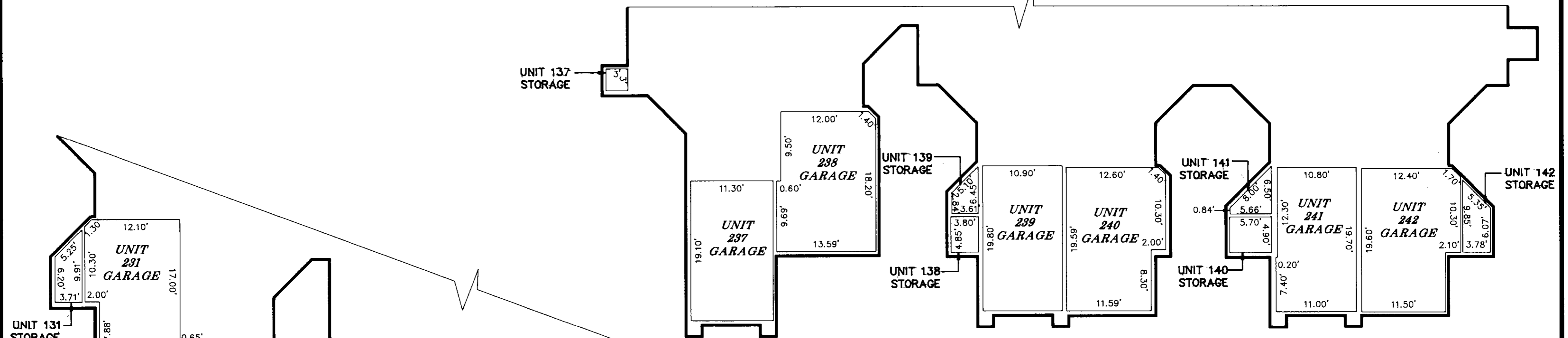

BUILDING G GARAGES AND STORAGE AREAS

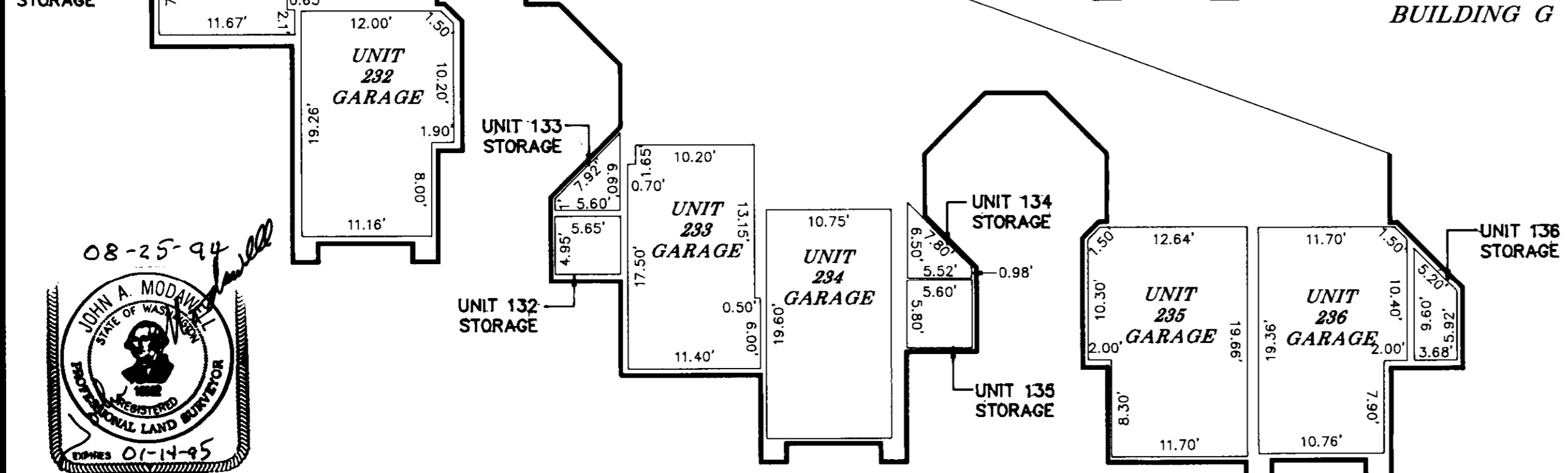

BUILDING F GARAGES AND STORAGE AREAS

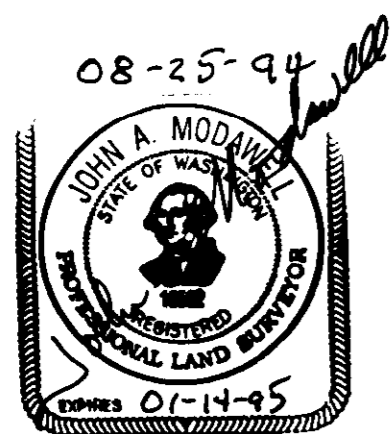

SCALE: 1" = 10'



CONCEPT ENGINEERING, INC.
455 Rainier Boulevard North, Suite 200
Issaquah, Washington 98027
(206) 392-8055