

# THE VILLAGE AT MONTREUX A CONDOMINIUM - PHASE I

SITUATE IN THE NW 1/4 OF SEC. 19, TWP. 24 N., R. 6 E., W.M.,  
CITY OF ISSAQUAH, KING COUNTY, WASHINGTON

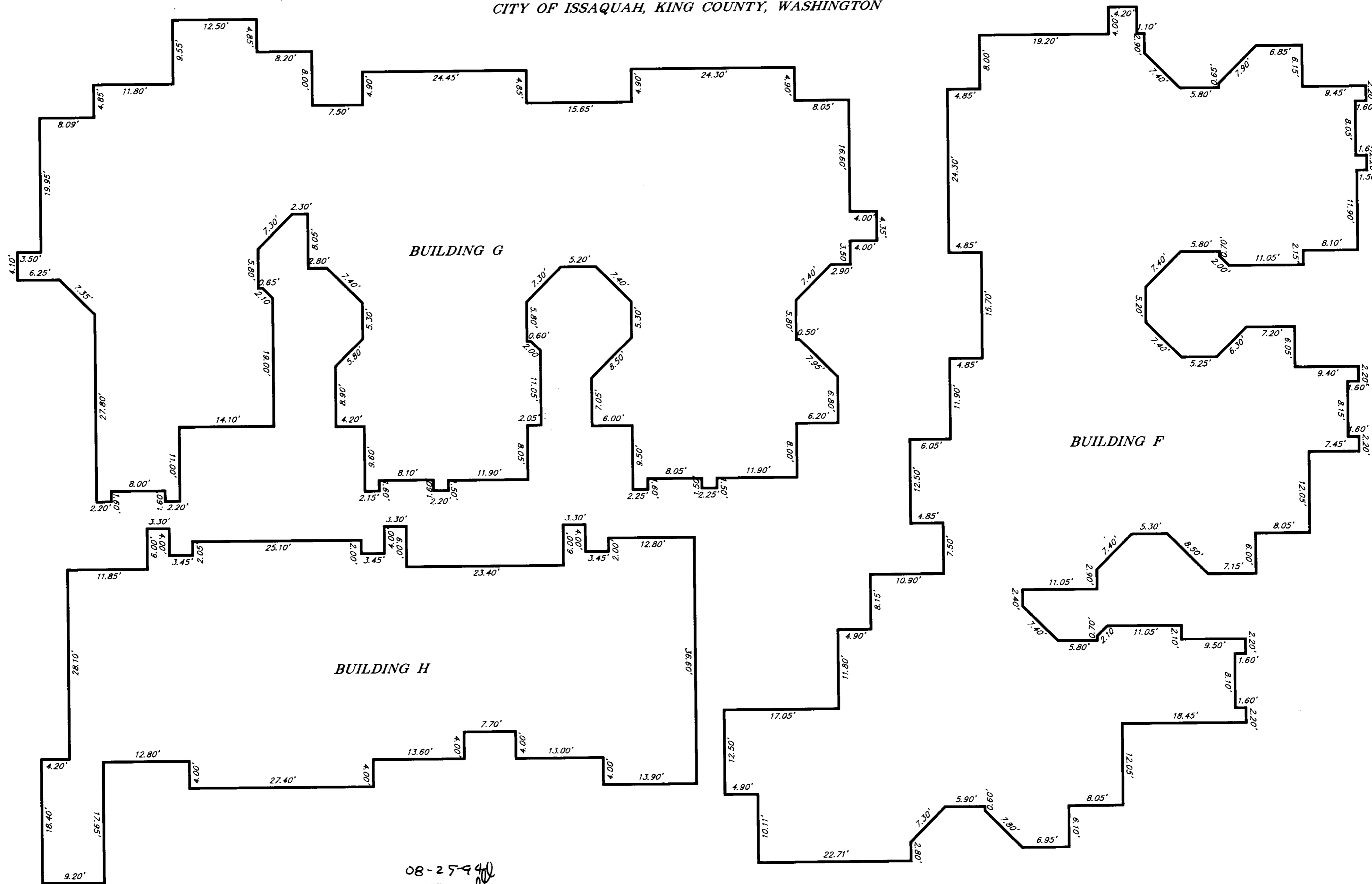

CONCEPT ENGINEERING, INC.  
455 Rainier Boulevard North, Suite 200  
Issaquah, Washington 98027  
(206) 392-8055

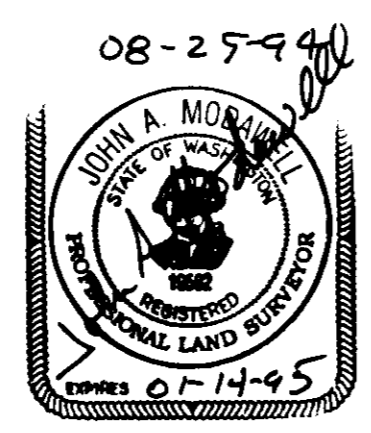

EXTERIOR BUILDING DIMENSIONS

SCALE: 1" = 10'